

IFB

DeepClean[®]

POWERED BY 

WASHING DRYER REFRESHER USER MANUAL

EXECUTIVE PLUS 10/7.0/3.0 KG1400RPM

UF421PKMAN762 B

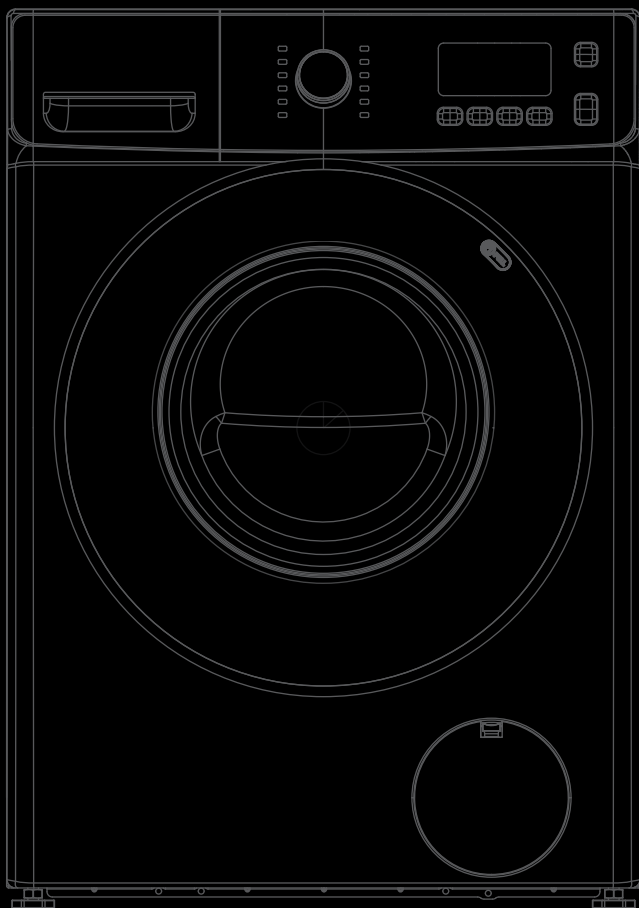

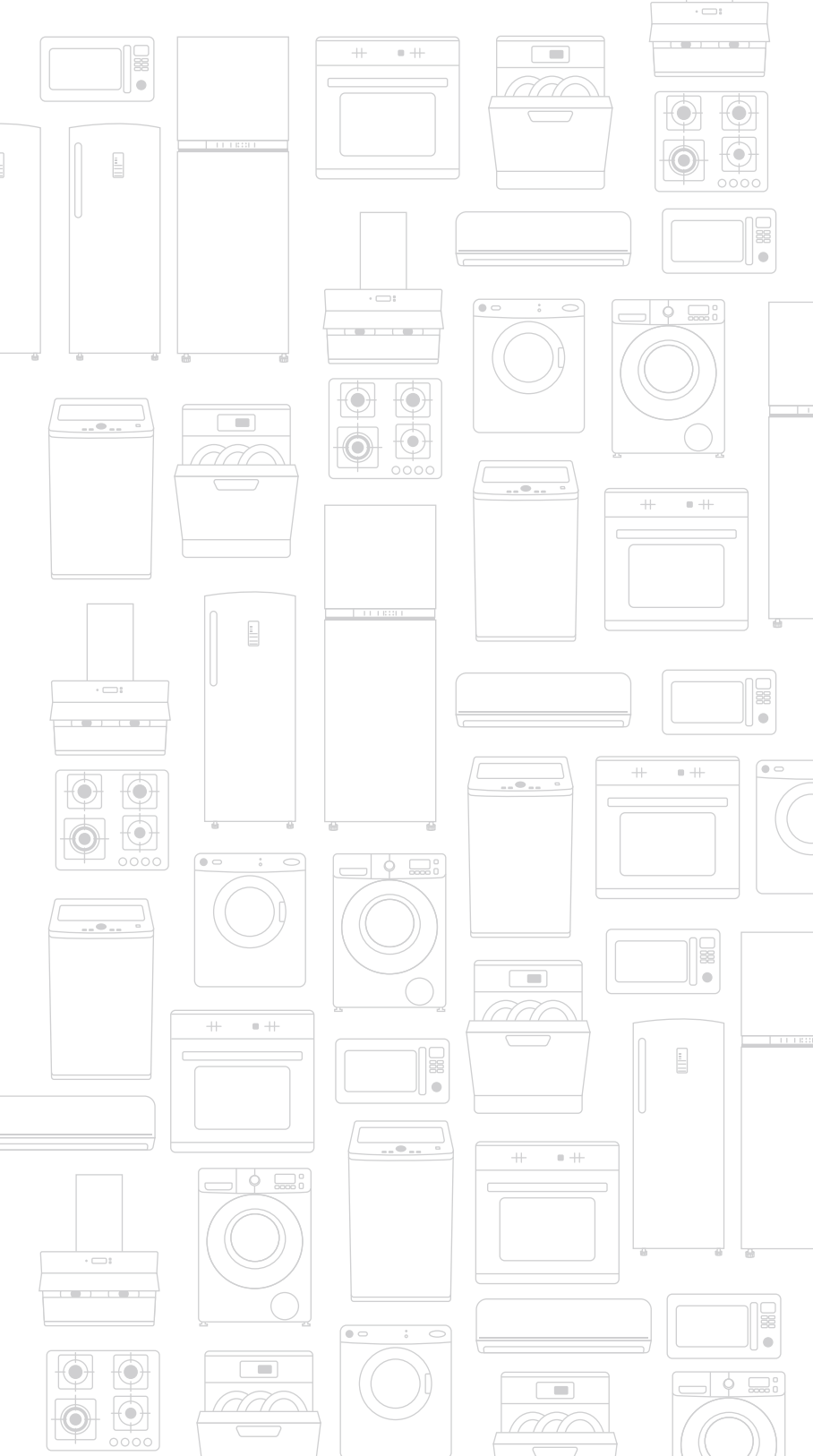

Welcome to the IFB Family

Get ready to experience excellence
in washing and long lasting peace
of mind. Happy Laundry Days to you!

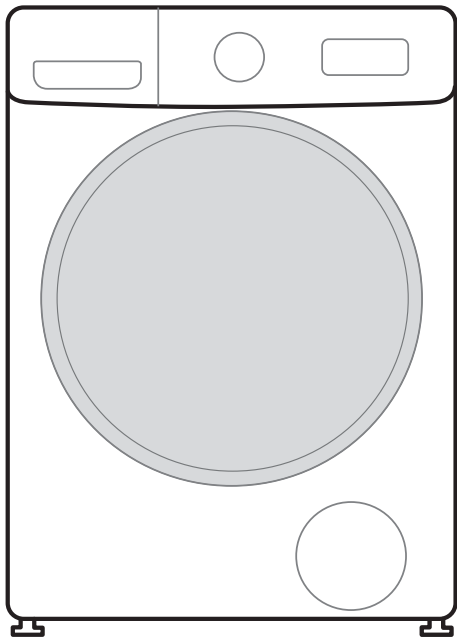

Washer Dryer Refresher

Contents

The A to Z of Your Washing Machine	06
The Display Panel	08
Safety Guidelines	
Installation	15
Instructions	17
Caution	19
About eWaste	25
Section 1 Getting Started With Your Washing Machine	
Installation and Safety Guidelines	27
Before You Start	31
Section 2 Running Your Machine	
6 Easy Steps For Doing Your Laundry	32
Finishing	40
Program Guide	43
Wash Options	46
Wash Guide Map	56
Key Features	63
Section 3 Getting More From Your Machine	
Tips for Best Results	68
Stain Treatment	70
Maintenance and Cleaning	74
Section 4 Useful Information	
Troubleshooting	81
Display & Error Codes	90
Technical Specifications	94
Revisions Sheet	95

PRECAUTIONS

This appliance meets the required safety standards, but using it improperly could cause injury or property damage. Make sure to read this manual carefully—it covers safety, installation, use and maintenance. Use detergents with low foam to prevent any problems. Following these guidelines will help you get the most out of your new washing machine and keep it running smoothly while avoiding accidents or damage.

The A to Z of Your Washing Machine



The A to Z of Your Washing Machine

Power ON/OFF

Options/Essentials

Aroma

Steam

Rinse

WiFi/WiFi AP

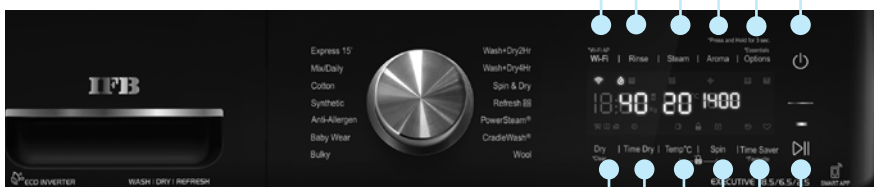

Dry/Clear

Time Dry

Temperature

Spin

Time Saver/
Favourite

Start/pause

The Display Panel

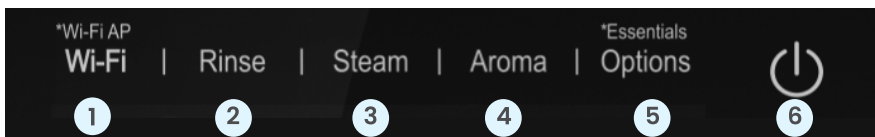

1 **WIFI/WIFI AP* BUTTON**

To connect your machine in WiFi Direct or WiFi Remote mode

2 **RINSE BUTTON**

To select Extra Rinse option.

3 **STEAM BUTTON**

To select Steam option.

4 **AROMA BUTTON**

To select Aroma option.

5 **OPTIONS/ESSENTIALS* BUTTON**

To select the different options available for the program.

6 **POWER ON/OFF BUTTON**

To turn ON and switch OFF the machine.

The Display Panel

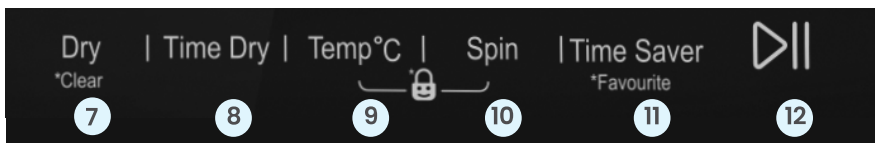

7 DRY/CLEAR BUTTON

To select and deselect Dry options.

8 TIME DRY BUTTON

To select Time Dry option.

9 TEMPERATURE BUTTON

To select the different temperatures available.

10 SPIN BUTTON

To select the different spin speeds available.

11 TIME SAVER/FAVOURITE BUTTON

To select Time Saver/Favourite option.

12 START/PAUSE

To Start/Pause the machine or program.

Single Press or Touch the button for selecting any function. Press or Touch and Hold the button for 3-5 secs to select the functions with * marks.

Note Status symbols glow when their respective settings are in operation

The Display Panel

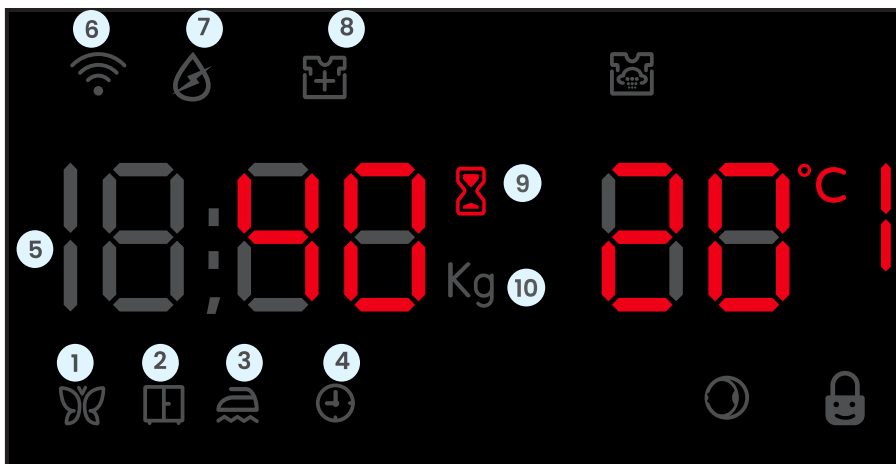

1 GENTLE DRY

Drying option for delicate fabrics

2 CUPBOARD DRY

Drying option for clothes ready to put into the cupboard

3 IRON DRY

Drying option leaves clothes slightly damp, ready to iron

4 TIME DRY

Set the drying time as required

5 TIME

Indicates the program cycle time

6 WiFi

Glows when connected to WiFi

7 TAP

Glows during water filling

8 EXTRA RINSE

Option for additional rinse

9 TIME LEFT

Glows to indicate the time left

10 KG

Glows to indicate the maximum capacity of the program in Kg

The Display Panel



11 DOOR

Glows when the door is open, flashes during door unlocking and remains OFF when the door is locked

12 CHILD LOCK

Glows when activated

13 LAUNDRY ADD

Glows to indicate the function is available in Pause Mode

14 TIME SAVER

Glows to indicate the function is available

15 FAVOURITE

Glows to indicate favourite program

16 INDICATES

Temperature settings selected

17 INDICATES

Selected Spin Speed settings

The Display Panel

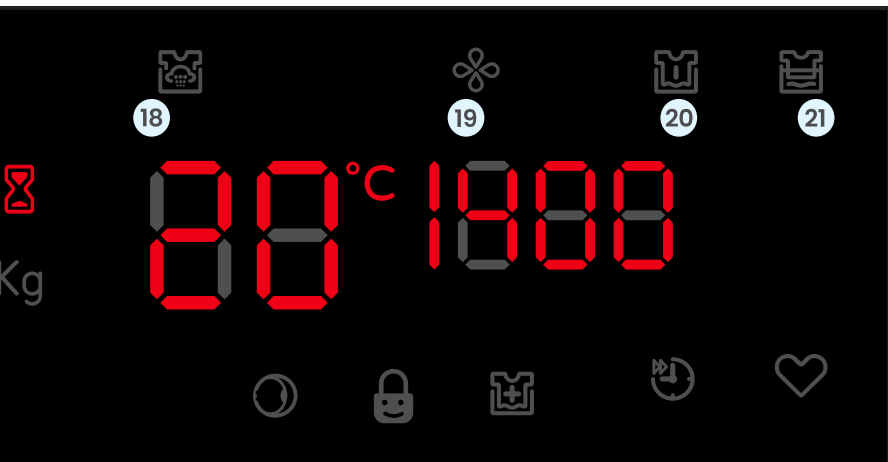

18 STEAM

Steam function

19 AROMA

Indicates aroma option

20 PRE WASH

Choose the Pre Wash function

21 SOAK

Choose the Soak option

Symbol status for Extra Rinse, Steam, Aroma, Pre Wash, Soak, Dry Modes, Time Dry and Time Saver
GLOW Function is selected
FLASH Function available for selection
OFF Function not selected or cannot be selected

Your Washing Machine

Smart moves to get your laundry right!

ADVANCED WASH TECHNOLOGY



Smart phone

Compatible washing with WiFi connectivity, download the IFB app. Let Xpert Wash guide you.



Time Dry



Time Save

In a rush?

Get the laundry done quick with Wash + Dry 2 hr program Or select the Time Saver option with any program



Extra Rinse



Hot Rinse



Steam



Tub Clean

99.99% germ free wash for clothes

Get hygienic clothes and stay healthy with Extra Rinse, Steam, Hot Rinse and Tub Clean.



Steam



Tub Clean



Hot Rinse

Clean with Steam

Choose Steam with any program and try IFB's unique Power Steam™ with 2X steam for germ free, soft clothes!

Your Washing Machine

Smart moves to get your laundry right!

ADVANCED WASH TECHNOLOGY



Steam

Refresh special clothes in a jiffy!

Put in 1-2 items and turn the knob to the Refresh wash program. Removes odours and wrinkles from clothes—your party clothes are ready to wear in almost no time at all.



Laundry Add

Forgot to add something?

Pause the wash and use the Laundry Add Option to put in clothes



Cupboard Dry

5 drying modes for the complete laundry experience

Customise drying as per your preference—ready to put into the cupboard, ready to iron or gentle drying for your delicates



Gentle Dry



Iron Dry



Time Dry



Eco Dry



Safety Guidelines

FOR INSTALLATION

Read all instructions & explanations carefully before installation. Choose the area where the machine will be placed carefully after reading the requirements.



Keep the packaging material. It may come in handy when shifting residence.

Not removing all packaging and transit bolts before using your appliance could damage your appliance. Please do not operate your machine until the transit bolts have been removed.



Pre-installation plumbing and electrical connections must be handled by qualified fitters, electricians, or technicians.

All washing machine installation work must be carried out only by authorised IFB Care Service Personnel.

Use only the new hoses provided with the machine; old hoses should never be reused.

Do not connect your machine to a hot water supply.

This machine works best with water pressure between 0.3 and 10 bar (that's about 3.5 to 10 litres/ minute). If the water pressure is too low, your machine might malfunction.



Your machine comes with ventilating openings on the base. Always put it directly on the floor after removing any carpets.

Keep your machine safe from direct sunlight and rainfall.

Avoid installing the machine in damp areas or bathrooms exposed to direct showers

Don't put the machine on a sloping, uneven, or unstable surface.

Make sure your machine is installed in a room with adequate ventilation. Don't pick a room without windows. And make sure there's at least 4 inches (100 mm) of space between the back of the machine and the wall.

Don't put your washing machine in places where the temperature is below freezing. If hoses freeze, they could burst when under pressure. Also, the electronic control unit might not work if it's too cold (below freezing) or too hot (above 50 °C).

A concrete floor is recommended for installation, as it reduces vibration during the spin cycle compared to wooden floorboards.

Ensure the machine is placed on a stable, level surface to prevent vibrations during operation. All four washer feet should be levelled and balanced against the floor.

Before cleaning your machine, make sure you disconnect the main electricity supply & remove the plug from the socket.

Don't use your appliance near flammable stuff like oil, benzene, or highly flammable gas. These might start fires or explosions. And don't use combustible detergents that can catch fire either.



Safety Guidelines

INSTRUCTIONS FOR USE

Safety first, always. Make sure you read all the instructions carefully before you start using the appliance. Keep the operating instructions handy for future reference



Remember, if cockroaches or other pests cause any damage, the appliance guarantee won't cover it.

Don't install or use a machine that's damaged. Before you plug it in, check if the connection details on the data plate (like fusing, voltage and frequency) match your electricity supply. If you're not sure, reach out to IFB Care for help.

Avoid washing or drying articles contaminated with combustible or explosive substances, such as oil, paint, gasoline, or solvents, to prevent fire or explosions.

Before using the machine for the first time, ensure the transit bolt at the rear is removed (refer to the installation section).

If you're leaving the machine for a while, for example if you're going on holiday, remember to turn OFF the stopcock, especially if there's no floor drain nearby.

Keep children away from the appliance, and closely supervise them when the machine is in use.

Appliances are not intended for use by children. Parents or legal guardians are responsible for supervising or training children on safe product usage. Do not let children clean or maintain appliances without adult supervision.

Safety Guidelines

Do not use items if industrial chemicals have been used for cleaning.

Do not use items containing foam rubber (also known as latex foam) or similarly textured materials. Foam rubber can, when heated, produce fire through spontaneous combustion.

Do not use items rinsed in fabric softeners to eliminate the effects of static electricity unless recommended by the manufacturer of the fabric softener or product.





Caution

Undergarments that contain metal reinforcements should not be placed in the dryer. Loose metal reinforcements could damage the tumble dryer.

Do not use underwear trimmed with lace in the tumble dryer. Doll cushions, and trims on dress suits may come loose.

Do not use plastic articles such as shower caps or babies' waterproof napkin covers in the tumble dryer.

Do not use the rubber backed articles, clothes filled with rubber pads, rubber boots or rubber coated tennis shoes in the tumble dryer.

Do not dry unwashed items in the tumble dryer.

Do not use the drying function after applying a chlorine bleach agent to the laundry during a wash or drying cycle. Otherwise, the laundry may become discoloured or the material may be damaged.

Do not use the drying function for clothing with fur lining or made from acrylic material. This may result in the drying function being degraded.

Do not touch the insides of the drum or the washing machine surface during or just after drying as it may be hot. This may result in burns.

Do not use heat sensitive garments made from leather, mink, fur, silk etc.

Do not use clothes trimmed with buttons in the tumble dryer. Heat can cause them to break.

Do not use hard bleeding clothes.



Caution

A WORD OF WARNING



The manufacturer isn't responsible if there's a problem with the earthing system. Make sure your machine is connected to a grounded outlet with a 16A Fuse or MCB. If you're unsure whether the machine is properly grounded, get it checked by a qualified technician or licensed electrician.

If the earthing connection is not properly carried out, it could lead to electric shocks.

Make sure the machine is connected to a 3-pin socket with good earthing and 16 Amp MCB for protection against short circuits.

Avoid using extension cables with the appliance for safety reasons, as they do not meet the required levels of safety.

When disconnecting the plug, hold the plug itself, not the cord. Don't insert or remove the plug with damp hands.

Overheating could be a real danger.

Your machine has been built according to current safety requirements.

Your machine is totally disconnected from electricity when you switch it OFF at the wall socket and remove the plug, or turn it OFF from the main source, or remove the main fuse, or switch OFF the MCB.



Caution



Letting unauthorised mechanics repair your machine, may pose unforeseen dangers. Only authorised IFB Care Service Personnel should undertake repairs.

Only use a new hose kit to connect your machine to the water supply on site. Don't try to reuse old hoses. If any parts need replacing, make sure to use genuine IFB spare parts. That way, you can be sure your machine meets safety standards.

Faulty connection cables must be replaced by authorised IFB Care Service Personnel to prevent potential danger to the user.

Never stack a washer and dryer without the proper stacking kit. This is dangerous because the dryer could shake off the washing machine while it is in use.

First use after installation—Condensed water droplets may remain inside the drum after assembly and test run. Run the first cycle without garments. Use the Cotton program at the highest temperature, add detergent, DO NOT put any clothes in the machine.

If the trolley vibrates excessively, it needs to be replaced right away. Otherwise, it could make the machine less reliable and shorten its lifespan.

If your machine has a porthole door, keep in mind that the glass might get hot when you're washing at high temperatures. Make sure children don't touch it.

Always ensure the drum is stationary before removing clothes to avoid accidents.

Avoid dragging the washing machine while it's running to prevent damage.



Caution

Keep your machine dry to avoid corrosion/rusting.

Don't spill water on the machine. If spills occur, wipe it dry. Your machine should be kept away from floor cleaning chemicals. Don't wash or spray water over the switch or control panel. Keep the machine dry to prevent corrosion and rusting. Make sure to wipe the machine after cleaning the coin trap.



Don't wash shoes or utensils in this appliance.

Check the labels on your clothes for the washing instructions for the fabric.

Use detergents that have been recommended for this washing machine.

Only use dyes specified by the manufacturer for domestic washing machines. Make sure to follow the manufacturer's instructions carefully.

Never use solvent-based cleaning agents in the machine. They can damage parts and produce dangerous fumes. Plus, they can also increase the risk of fire and explosions.

If your clothes have been treated with solvent-based cleaning agents before washing, make sure to rinse them really well in clean water before you put them in the machine.

Avoid using colour run and dye removers containing sulphur compounds, as they can cause corrosion or damage.



Caution

Your machine has been built according to current safety requirements.

During assembly, the machine is tested with water to make sure it performs correctly. Sometimes, a few water droplets may be left inside the drum.

Replace the trolley immediately if excessive vibrations are observed, as it can affect the machine's reliability and lifespan.

Flooding Danger

When you're connecting the drain hose to a washbasin, make sure the water drains away fast to stop the sink from overflowing. Also, make sure the hose is firmly in place so the water flow doesn't push it out. Otherwise, you might end up with flooding.

Be careful to not let things like nails, pins, coins, or paper clips end up in the machine with your laundry. They can damage parts like the suds container or drum, which can then ruin your clothes during the wash.

Caution Hot

Emergency Door Opening

Please use the emergency lever to open the door during power failure. This keeps your clothes safe as the inside chamber may be hot at the time the power failure happens.

Keep the door slightly open in case there is power failure during the drying phase and be careful not to touch the door glass and laundry immediately after opening the door as they will be extremely hot. For more details, please refer topic 'Emergency Door Lock Release'.



Caution

USE OF APPLIANCE

This appliance is not intended to be used in household and similar applications such as—

- Staff kitchen areas in shops, offices and other working environments,
- Farm houses,
- By clients in hotels, motels and other residential type environments,
- Bed and breakfast type environments, and
- Areas for communal use in blocks of flats or in laundrettes.

If the manufacturer wants to limit the use of the appliance to less than the above, this shall be clearly stated in the instructions.

About eWaste

eWaste, or Waste Electrical and Electronic Equipment (WEET), refers to discarded appliances using electricity. To responsibly manage eWaste, follow the guidelines below.



DOs

- Always dispose of end-of-lifecycle products by contacting an authorised local eWaste recycler.
- Do drop off used electronic products, batteries, or accessories at authorised eWaste recyclers.
- Sort packaging materials for responsible waste disposal and recycling options whenever possible or as instructed.



DON'Ts

- Do not dismantle electronic products on your own.
- Never dispose of electronic products in bins marked 'Do Not Dispose'.
- Refrain from giving eWaste to informal sectors like local scrap dealers or rag pickers.
- Do not dispose of your product in garbage bins along with municipal waste that ultimately reaches landfills.

RISKS OF IMPROPER HANDLING OF eWASTE

eWaste usually includes components which, if disposed of improperly, hold environmental consequences such as air, water and soil pollution and also pose risks to human health.

By ensuring your appliance is disposed of correctly, you will help prevent potential negative consequences for the environment and human health. Components and materials used in this washing machine are fully compliant with the Provisions of Hazardous Substances outlined in eWaste Management Rule, 2016.



FOR DETAILED INFORMATION AND DISPOSAL REQUEST
Contact **IFB Care** at **080 695 45678**. Provide your
details to our representative to arrange for proper
product disposal.

Getting started with your washing machine

Installation and Safety Guidelines

1 SELECTING THE RIGHT SPOT

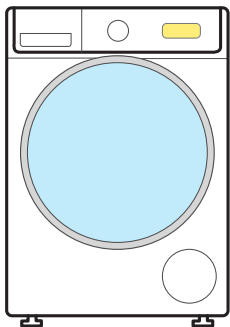

Place the machine on a level floor.

Make sure the machine is close to both water and electrical connections.



2 REMOVING TRANSIT BOLTS

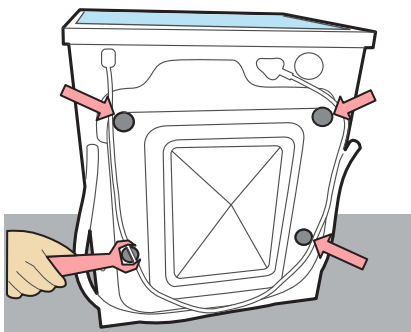

Use a spanner to remove the transit bolts.

Insert the plastic caps provided.

Keep the transit bolts carefully as they will be required in case you need to shift the machine.

Please do not operate the machine until the transit bolts have been removed.

SECTION 1

Getting started with your washing machine

Installation and Safety Guidelines

3 LEVELLING

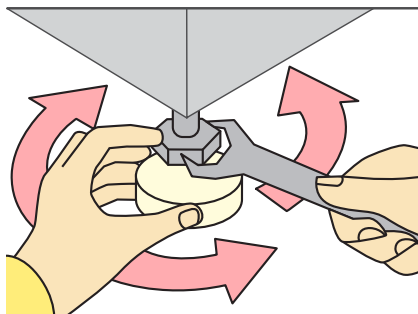

Level the machine by using adjustable screws, as shown.

Make sure all 4 feet are grounded.

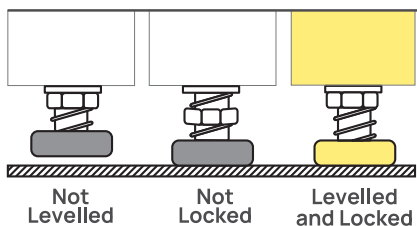
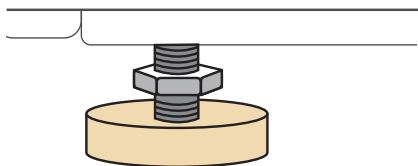
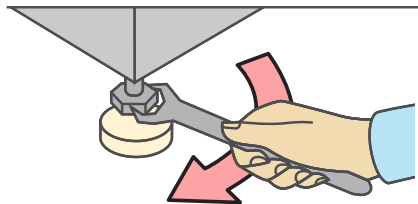

Getting Started With Your Washing Machine

Installation and Safety Guidelines

4 CONNECTION TO WATER SUPPLY

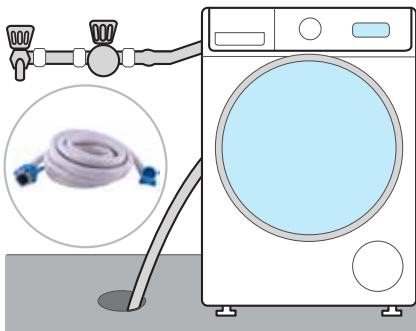

The water inlet of the machine has a collar with parallel internal threads.

Water supply point with a $\frac{3}{4}$ " external/parallel thread should be within 1 m of the machine.

Don't stretch the water supply hose.

Note After connecting inlet hose to water tap, turn on the water tap to flush out foreign substances such as dirt, sand or sawdust in the pipelines.

5 CONNECTION TO DRAIN HOSE

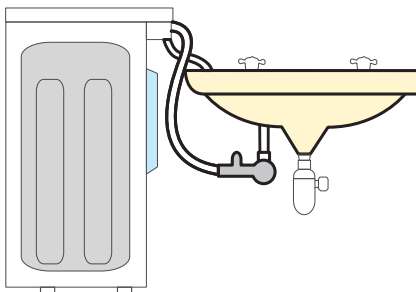

The machine uses a drain pump. Direct the end of the drain hose towards a sink.

The drain hose can be either placed on the floor or over a sink at a maximum height of 1 m from the floor.

SECTION 1

Getting Started With Your Washing Machine

Installation and Safety Guidelines

5 CONNECTION TO DRAIN HOSE (contd)

Is the sink on the **left** side? Follow this diagram.

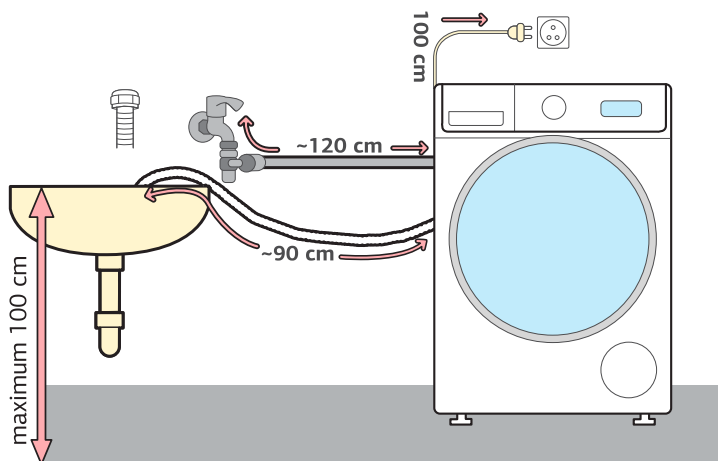

Is the sink on the **right** side? Follow this diagram.

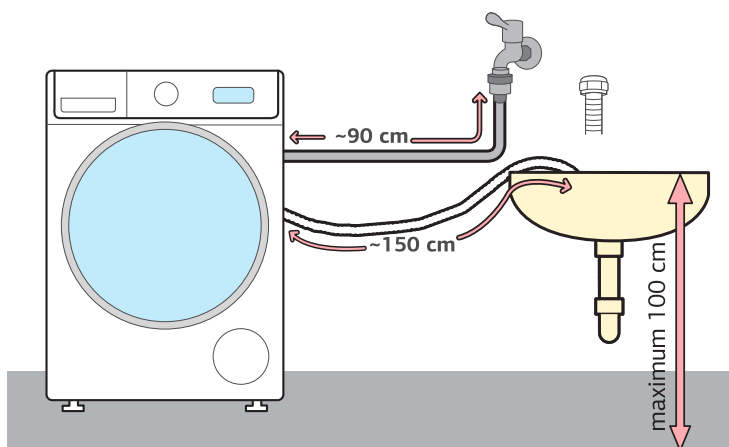

Getting Started With Your Washing Machine

Installation and Safety Guidelines

6 ELECTRICAL CONNECTION

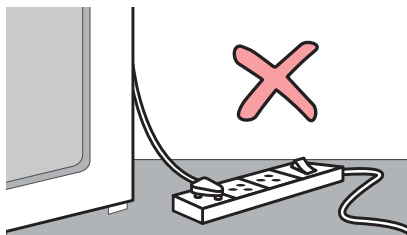

A 16 Amp, 3 pin 220-240 V AC, 50 Hz electrical point with a 16 Amp MCB within 1 m of the machine is mandatory.

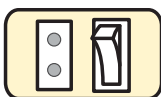

Make sure your home has proper earthing and the connection between the socket and the plug is firm.

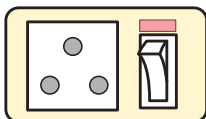

BEFORE YOU START

Make sure that the machine has been installed and connected as per the instructions above.

To remove any water left over from factory testing of your machine, the first wash cycle should be carried out without any laundry in the machine.

Turn ON the water tap,

- › Pull out the detergent drawer completely
- › Pour approximately 20 g of detergent in the dispenser
- › Close the drawer
- › Set the program selector knob to Cotton and maximum Temperature
- › Press Start/Pause
- › Switch OFF the machine when 'End' message is displayed.

Running Your Machine

6 Easy Steps for Doing Your Laundry

1 SORT THE LAUNDRY

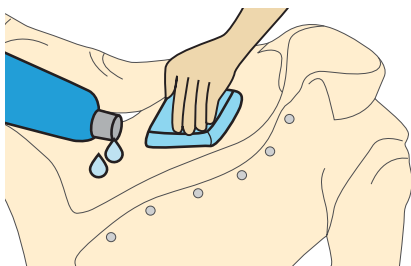

Pre treat collars, cuffs and stains.

Check for wash care symbols.

Close zippers, hooks and strings.

Empty the pockets of your clothes.

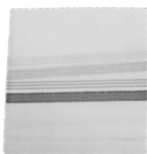

6 Easy Steps for Doing Your Laundry

2 LOAD THE LAUNDRY

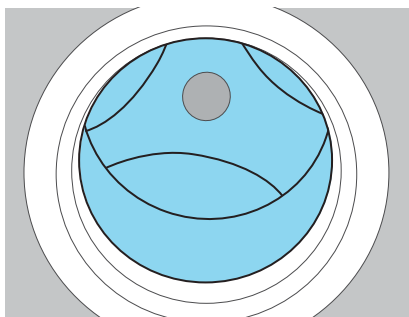

Make sure the laundry drum is empty.

Load garments one by one.

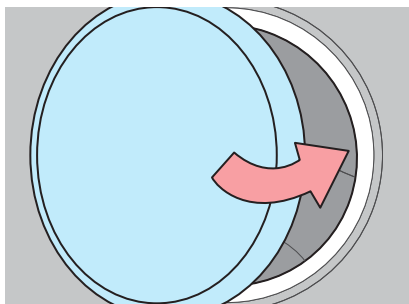

Close the door and press till you hear a click.

6 Easy Steps for Doing Your Laundry

3 ADD DETERGENT

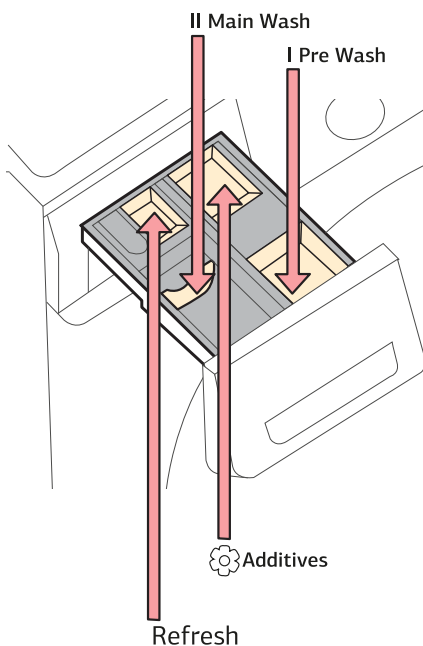

You can either use powder detergent or liquid detergent in this machine.

For Powder Detergent
Pull out the detergent dispenser drawer completely. Pull the flap up and dispense the correct amount of detergent in the Main Wash II compartment.

For heavily soiled clothes, use the Pre wash option and add detergent to the Pre wash I compartment. Close the detergent drawer.

Note Do not pull out detergent dispenser tray during water filling.

6 Easy Steps for Doing Your Laundry

3 ADD DETERGENT

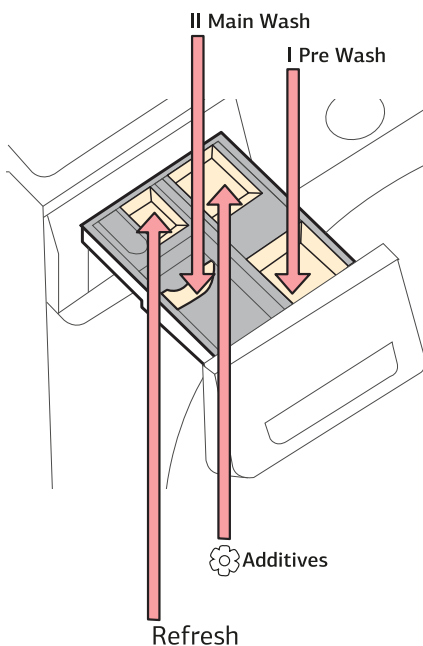

For Liquid detergent

Pull out the detergent dispenser drawer completely. Pull the flap up and dispense the correct amount of detergent in the Main Wash II compartment.

For heavily soiled clothes, use the Pre Wash option and add detergent to the Pre Wash I compartment. Close the detergent drawer.

Note When you use the liquid detergent— Always keep the flap down. Do not exceed the maximum level marked on the flap. Do not set the 'Pre Wash' phase. Do not set the 'Time Delay'. Do not use gelatinous or thick liquid detergents.

6 Easy Steps for Doing Your Laundry

3 ADD DETERGENT

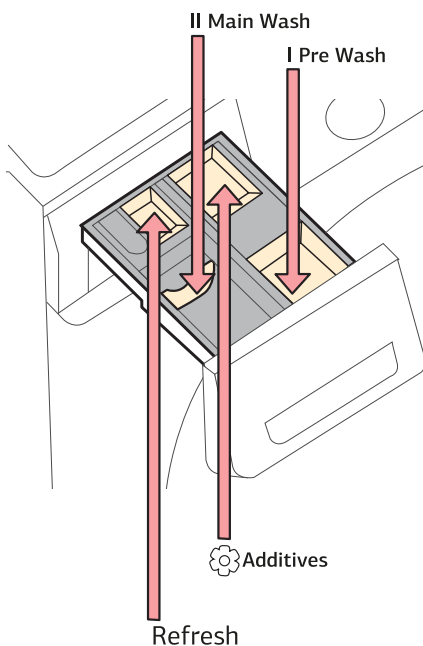

For Softener

Pull out the detergent dispenser drawer completely and dispense the correct amount of softener in the Additives compartment. Close the detergent drawer.

Note If the Aroma function is selected, do not add softener in the Additives compartment.

For Refresh and Aroma

Pull out the detergent dispenser drawer completely and dispense the correct amount of IFB Refresh Fragrance in the Refresh compartment. Close the detergent drawer.

**Note**

Always use detergents that are recommended for Front Load washing machine. Using the wrong detergent can cause laundry issues. Avoid using soap flakes or granulated soap powders in the machine. When washing woollens or silk, make sure to use the detergent type recommended by the manufacturer. If you notice too many suds, reduce the amount of detergent you're using.

6 Easy Steps for Doing Your Laundry

4 SELECT PROGRAM

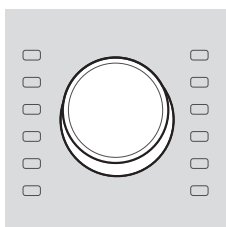

Switch ON the machine.

Turn the Program Selector knob to the required program.

Start/Pause LED will flash.

Choose Wash Option.



To change/cancel the program during the wash, press the Power ON/OFF button and wait for 2 secs, then select the new program.

For more information scroll to the **Program Guide** section.

5 SELECT WASH OPTIONS

Touch the option buttons to select button for the desired Wash Option.

For more information scroll to the **Wash Options** section.

6 START WASHING/DRYING



Press the flashing Start/Pause LED button to start washing/Drying.

To interrupt the cycle and change wash options or to add/remove laundry, press the Start/Pause button.

6 Easy Steps for Doing Your Laundry

6 START WASHING (contd)



Door status will be displayed after pressing the Start/Pause button.

If the Water Level inside the drum is above the rubber or the temperature inside the drum is high, the door won't open.

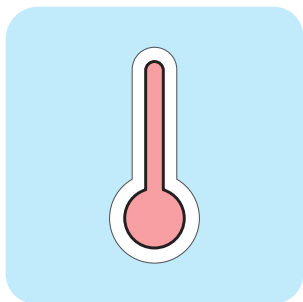

Once the wash is complete the 'End' message will appear. The door can be opened after this message.



The machine has been programmed to switch OFF all visual displays such as LEDs to save energy. Start/Pause LED will slowly blink after program ends. This is in line with the latest 'Energy Using Product' norms (EUP).

Finishing

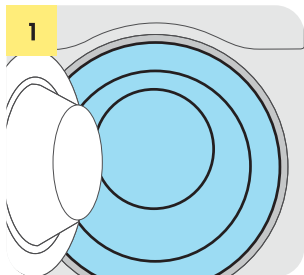

Please ensure you take the following steps after the program has ended to ensure the safety of your machine.

For washing

When program ends, 'End' message will be shown on the display.

The door can be opened after the above message is displayed.

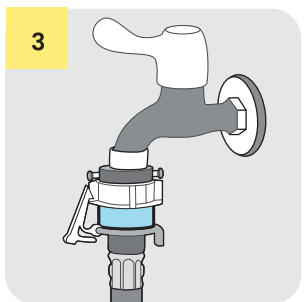
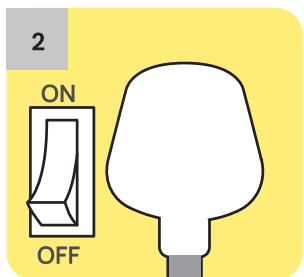

Finishing

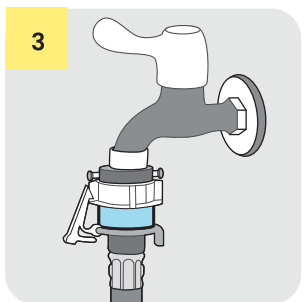
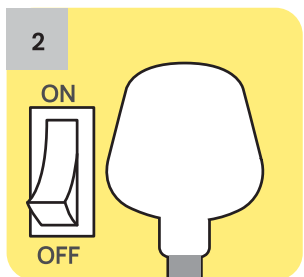
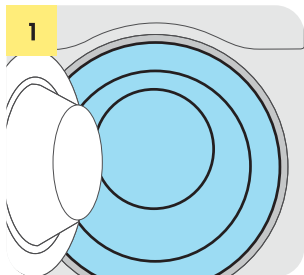

For drying

[d and End message will toggle on the display since the temperature inside the drum is high.

The program for cooling the drum runs until the temperature in the drum has dropped.

This process will last for 15 min with [d and End message toggling on the display.

You can touch the Start/Pause button or power OFF the machine to end this process. The door will then be unlocked and the laundry can be taken out.

Do not touch the inside of the drum or door surface just after drying as it will be hot.

Note The door cannot be opened during this step. Wait till END message is displayed to open the door.

Running Your Machine

India's First 3-in-1
LAUNDRIMAGIC™



WASH
10 Kg



DRY
7.0 Kg



REFRESH
3.0 Kg



Wash+Dry 2Hr

Express Wash+Dry in just 2 hours. Get your laundry done at one go.



Wash+Dry 4Hr

No need to wait for the wash cycle to complete and then move the clothes to your dryer. Wash+Dry at the touch of a button.



Refresh

A steam only program that removes wrinkles, eliminates odour, and 99.99% germs. Get fragrant, ready-to-wear clothes in minutes. You can avoid frequent dry cleaning by using this program.



Power Steam

A 30 minute program that uses steam twice during the wash, effectively eliminating germs. Maintains the texture, colour, and shape of your garment. Use for sportswear, gymwear, and uniforms. There is an exclusive option of drying, and adding a fragrance to your clothes.



Program Guide

PROGRAM	TYPE OF LAUNDRY
Mix/Daily	Cotton, synthetic and easy-care garments. Not recommended for special garments like silk/delicates, dark clothes, wool, duvets, curtains, etc.
Cotton/ Cotton Eco	Cotton colour-fast garments. Shirts, pants, uniforms, bed and table linen, towels, night dresses, pyjamas, underwear, etc.
Baby Wear	High temperature and extra rinses for better rinse performance. Recommended for baby clothes, underwear, cloth diapers, pillows, bedsheets, etc.
Anti Allergen	Cotton and linen fabrics that come in direct contact with the skin.
Express 15'	Lightly soiled coloured laundry made of cotton, linen, synthetic or blended fabrics.
Refresh 	For removing odour and de-wrinkling the laundry. Cotton, synthetic and mixed fabrics.
Wool	Machine washable woollen garments only. Use appropriate detergent.
Bulky/Bedding	Machine washable curtains made of cotton and easy care fabrics. Washes large items such as blankets, bedding covers, sofa covers, pillow covers and bedspreads

Running Your Machine

Program Guide

PROGRAM	TYPE OF LAUNDRY
Synthetic	Polyester, acrylic or polyamide daily wear garments.
CradleWash®	Hand wash and delicate wash garments. Silk, lingerie, satin, synthetic or sheer fabrics.
PowerSteam®	Lightly soiled cotton, synthetic and mixed fabrics items. This cycle removes stains effectively.
Wash + Dry 2 Hr/ Wash + Dry 4 Hr	Use for lightly soiled laundry, fabrics like cotton, synthetics and easy care garments. Do not use for special garments such as silk, duvets, delicates, dark clothes, wool, curtains etc.
Cupboard Dry/ Eco Dry	Use this program when you want to fold and put away the dried clothes. Can be used for everyday clothes such as cottons and mixed.
Iron Dry	Use this program to receive ready-to-iron cotton or linen fabrics, at the end of the cycle.
Gentle Dry	Use this program for easy care textiles and synthetic fabrics. It is suitable for easy care and mixed laundry clothes that require low temperatures for drying.
Time Dry	You can specify the drying time with this program. Set the time depending on the type of fabric, laundry load and moisture content.

Program Guide

PROGRAM	TYPE OF LAUNDRY
Aroma	Use this program to remove bad odours from the laundry.

***Note** To get complete drying, ensure that the laundry items are of similar material and thickness and avoid overloading the washing machine by stuffing too many items.

Do not tumble dry woollen laundry items.

Laundry items of woven and loop knit material may shrink based on the material quality. These items should be stretched back into shape soon after drying.

Permanent press and linen items should be taken out soon after the cycle ends to reduce wrinkles.

Always check the garment manufacturer's instructions.

Do not tumble dry any items made from or containing rubber or plastic items. Also avoid drying fibreglass articles in your washing machine to prevent skin irritation due to mixing of glass fibres with your other laundry.

Do not set drying programs for synthetic curtains, clothes with metal inserts, nylon stockings, quilts, bed covers, duvets, anoraks, sleeping bags, fabrics with residue of hair sprays, nail solvents or similar items.

Running Your Machine

Wash Options

OPTIONS

Details

Temp

Temperature

You can change the default temperature within a given range. Press the Temperature button on the control panel to change the temperature. The temperature selection sequence will be Cold, 20°C, 30°C, 40°C, 60°C, 95°C, Eco-Cold, Eco-20, Eco-30, Eco 40, Eco-60, Eco-95 and Repeat. The selected temperature will be displayed on the LED display. You can select more wash options or press the Start/Pause button to start the program.

Spin

Spin Speed

You can change the default Spin Speed in the given range.

Press the Spin Speed button on the control panel and select from No Spin, 400 RPM, 600 RPM, 800 RPM, 1000 RPM, 1200 RPM, 1400 RPM, Rinse Hold and Repeat.



Options

Rinse Hold

If clothes are left unattended for a long time it may cause creasing.

This option pauses the program during its final rinse to prevent this.

End message will appear on the display.

You can cancel the current program or input your desired Speed/Spin and continue.

Press Spin Speed option till End is displayed.

Running Your Machine

Wash Options

OPTIONS

Details



Options/IFB essentials

Touch the Options button on the control panel to select the various options available.

To scroll through them, touch the Options button until the desired option is highlighted.

Different options such as Pre Wash and Soak can be selected using the Options button. The corresponding symbol will glow once the desired option is selected.

Other available options such as Extra Rinse, Steam, Aroma and Time Saver can be selected using their respective buttons.



Essentials

Touch and hold the Options/Essentials button on the control panel for 3 secs to order IFB essentials. A single beep will sound. Further details of order will be received via SMS on registered mobile number.

Selection of Options

During option selection, the corresponding symbols will flash.

During option selection, the default or already selected option symbol will glow.

Non-available option symbols will remain OFF.

Touch the Options button to select the required option. The corresponding symbol will glow indicating the option has been selected.

Running Your Machine

Wash Options

OPTIONS**Details**

**Pre Wash**

If Pre Wash option is selected, the clothes are given a preliminary wash before the main wash.

Touch the Options button on the control panel once to select the Pre Wash option.

The Pre Wash symbol LED both will glow indicating that the option has been selected.

You can select more wash options or press the Start/Pause button to start the program.

Soak

Soak clothes in soapy water for a calculated amount of time to more easily dislodge soilage during the main wash cycle. After this, it automatically continues with the normal wash cycle.

During soaking, the clothes will remain stationary for about 10 mins.

Touch the Options button on the control panel twice to select the Soak option.

The Soak option symbol will glow, indicating that the option has been selected.

You can select more Wash Options or touch the Start/Pause button to start the program.

It is not advisable to soak coloured garments for a long time because they are likely to bleed colour.

Running Your Machine

Wash Options

OPTIONS

Details



Time Saver/Favourite

This option allows you to save time by decreasing the program time.

Touch the Time Saver button on the control panel to select & deselect the Time Saver option.

The Time Saver option symbol will glow, indicating that the option has been selected.

You can select more Wash Options or touch the Start/Pause button to start the program.



Favourite

The Favourite option allows you to set any program along with options as a favourite program.

To set a program as favourite, select the required program and options.



Touch and hold the Time Saver/Favourite button Eco button on the control panel for 3 secs to set the program as a favourite option.

The Favourite option symbol will glow, indicating that the program has been set as favourite.

To select or deselect the Favourite program, touch and hold the Eco button for 3 secs.

Running Your Machine

Wash Options

OPTIONS	Details
	<p>Extra Rinse</p> <p>An additional rinse cycle is executed to remove any residual detergent from fabrics, giving them a softer texture. A maximum of 3 additional rinses can be selected.</p> <p>Touch the Rinse button on the control panel to select the Extra Rinse option. The Extra Rinse option symbol will glow, indicating that the option has been selected.</p> <p>Extra Rinse 1–3 can be selected depending upon the program selected.</p> <p>You can select more options or touch the Start/Pause to start the program.</p>
	<p>Hot Rinse</p> <p>A Hot Rinse cycle is executed during the additive step, for an effective and thorough wash.</p> <p>The Hot Rinse option can only be selected via My IFB mobile App.</p> <p>You can select more wash options or touch the Start/Pause button to start the program.</p>
	<p>Steam</p> <p>When the Steam option is selected, steam is produced inside the drum—at the optimum wash time to enhance the wash.</p> <p>Touch the Steam button on the control panel to select Steam or Time Saver Option.</p> <p>Steam LED will glow indicating that the Option has been selected.</p> <p>You can select more wash options or touch the Start/Pause button to start the program.</p>

Running Your Machine

Wash Options

OPTIONS

Details



Aroma

Use this option to remove bad odours from the laundry.

Touch the Aroma button on the control panel to select and deselect the function.

The corresponding symbol will glow, indicating that the option has been selected.

***Note** Steam option can be selected for Cotton, Synthetic, Mix/Daily, Anti Allergen, Wash+ Dry 4Hr, Bulky, Baby Wear, Steam & Dry, Refresh and PowerSteam® programs.

It is normal that steam may not be visible during the Wash/Steam cycle.

Do not touch the door during the Steam cycle as the surface may be very hot.

Do not attempt to open the door forcibly or reach into the machine during the Steam cycle. The steam can cause severe burns.

Dry
*Clear

Dry/Clear

Touch the Dry button on the control panel to select the drying options available.

Scroll through the options, touch the Dry button until the desired option is highlighted.

Selection available—Iron Dry, Cupboard Dry, Gentle Dry, and Repeat.

The corresponding symbol will glow once the desired option is selected. Other dry option such as Eco dry can be selected via MY IFB app.

Clear

Use this button to deselect all the dry options selected. Touch and hold this button for 3 secs to clear all the dry modes selected.

Running Your Machine

Wash Options

OPTIONS**Details**

To select the Dry option with program/only Dry

Select the required program for washing.

The Dry option LED will flash and the default dry option symbol will glow (which can be deselected).

Dry options can be selected/deselected using the Dry button on the control panel.

The first press of the Dry button will select Iron Dry. Every subsequent press of the Dry button will select the other dry options in the following sequence—Cupboard Dry, Gentle Dry, and Repeat.

The selected Dry option LED will glow and the available Dry option LED will flash.

Note

Dry option is available for Cotton, Synthetic, Mix/Daily, Express 15', Baby Wear, Steam & Dry, Anti Allergen, Refresh, Power Steam, Wash + Dry 4 Hr, and Wash + Dry 2 Hr programs.

Running Your Machine

Wash Options

OPTIONS	Details
<div>Spin</div> <div>+</div> <div>Temp</div>	<p>Child Lock</p> <p>This activates protection against unintentional changes to the program sequence.</p> <p>To select Child Lock, press the Spin and Temperature buttons simultaneously for 2 secs.</p> <p>No changes can be made while the program is running.</p> <p>If the appliance is switched OFF, it will resume from where it was interrupted in this mode.</p> <p>The door will remain locked till the end of the program.</p> <p>You can disable this option the same way you enabled it.</p>



EMERGENCY DOOR LOCK RELEASE

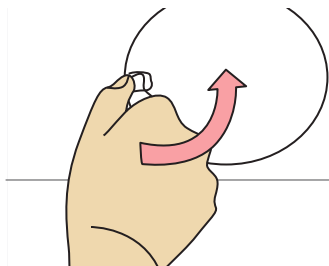

Note Emergency door lock release should be used only during power OFF/power failure. Using this ends the current program.



PRECAUTIONS TO BE TAKEN FOR THE ABOVE

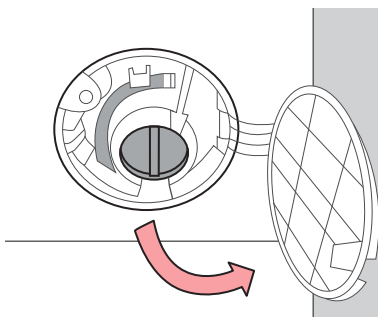

Let the wash water cool down if it is hot.

Don't remove laundry from the drum while it is rotating.

Drain the water from the drum using the emergency drain pipe before releasing the door lock to avoid damage.

EMERGENCY DOOR LOCK RELEASE DURING POWER FAILURE

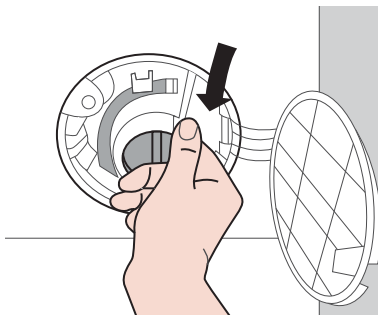

Program will continue after power supply resumes. If you still want to remove the laundry, switch OFF the power supply from the mains. Open the filter door, drain the water through the drain hose and then pull down the emergency lever to open the door.

Running Your Machine

Washing Symbols—A Guide



RESISTANT MATERIAL



DELICATE FABRIC



WASHABLE AT 95°C



WASHABLE AT 60°C



WASHABLE AT 40°C



WASHABLE AT 30°C



HAND WASH



DRY CLEAN ONLY



WOOL SEAL



BLEACHABLE IN COLD WATER



DON'T BLEACH



DON'T DRY CLEAN



DRY FLAT



HANG TO DRY



DRY ON CLOTHES HANGER



THE ITEM CAN BE TUMBLE DRIED



TUMBLE DRY, NORMAL HEAT



TUMBLE DRY, REDUCED HEAT



DON'T TUMBLE DRY

Running Your Machine

Wash Guide Map

	PRE WASH	SOAK	ECO	TIME SAVER	ANTI CREASE	EXTRA RINSE	HOT RINSE	STEAM	AROMA	RINSE HOLD	DRY	DELAY
--	----------	------	-----	------------	-------------	-------------	-----------	-------	-------	------------	-----	-------

Wash + Dry 2 Hr

×	×	×	×	×	✓	×	✓	✓	✓	✓	✓
---	---	---	---	---	---	---	---	---	---	---	---

Temperature °C Cold, 30, 40 | Laundry Weight in Kg. 2.5

Spin Speed RPM 400–1200 | Favourite ✓

Wash + Dry 4 Hr

✓	✓	✓	✓	✓	✓*	✓	✓	✓	✓	✓	✓
---	---	---	---	---	----	---	---	---	---	---	---

Temperature °C Cold, 20, 30, 40 | Laundry Weight in Kg. 5.0

Spin Speed RPM 400–1200 | Favourite ✓

Spin & Dry

×	×	×	×	✓*	✓	×	✓	✓	✓	✓	✓
---	---	---	---	----	---	---	---	---	---	---	---

Temperature °C ✗ | Laundry Weight in Kg. 6.5

Spin Speed RPM 400–1400/No Final Spin | Favourite ✓

Refresh



×	×	×	✓	✓*	×	×	✓*	×	×	✓	×
---	---	---	---	----	---	---	----	---	---	---	---

Temperature °C ✗ | Laundry Weight in Kg. 1.0 or (1-3 items)

Spin Speed RPM ✗ | Favourite ✓

Note 40E, 60E programs—some options are not available | ** Program setting for BEE test in conformity with IEC 60456 with 1400 Spin Speed selection settings.

✓ Option available for selection

✗ Option not available for selection

✓* Available by default and cannot be deselected

✓• Option available by default and can be deselected

Running Your Machine

Wash Guide Map

	PRE WASH	SOAK	ECO	TIME SAVER	ANTI CREASE	EXTRA RINSE	HOT RINSE	STEAM	AROMA	RINSE HOLD	DRY	DELAY
--	----------	------	-----	------------	-------------	-------------	-----------	-------	-------	------------	-----	-------

PROGRAM

PowerSteam®

✗	✗	✗	✗	✗	✗	✓	✗	✗*	✗*	✓	✓	✓
---	---	---	---	---	---	---	---	----	----	---	---	---

Temperature °C ✗ | Laundry Weight in Kg. 3.0

Spin Speed RPM 400–800 | Favourite ✓

CradleWash®

✗	✗	✗	✗	✗	✓	✗	✗	✗	✓	✗	✓
---	---	---	---	---	---	---	---	---	---	---	---

Temperature °C Cold, 30, 40 | Laundry Weight in Kg. 2.0

Spin Speed RPM 400–600/No Final Spin | Favourite ✓

Wool

✗	✗	✗	✗	✗	✓	✗	✗	✗	✓	✗	✓
---	---	---	---	---	---	---	---	---	---	---	---

Temperature °C Cold, 30, 40 | Laundry Weight in Kg. 2.0

Spin Speed RPM 400–800/No Final Spin | Favourite ✓

Express 15'

✗	✗	✗	✗	✗	✓	✗	✗	✓	✓	✓	✓
---	---	---	---	---	---	---	---	---	---	---	---

Temperature °C Cold, 30, 40 | Laundry Weight in Kg. 3.0

Spin Speed RPM 400–1200/No Final Spin | Favourite ✓

Note 40E, 60E programs—some options are not available | ** Program setting for BEE test in conformity with IEC 60456 with 1400 Spin Speed selection settings.



Option available for selection



Option not available for selection



Available by default and cannot be deselected



Option available by default and can be deselected

Running Your Machine

Wash Guide Map

	PRE WASH	SOAK	ECO	TIME SAVER	ANTI CREASE	EXTRA RINSE	HOT RINSE	STEAM	AROMA	RINSE HOLD	DRY	DELAY
--	----------	------	-----	------------	-------------	-------------	-----------	-------	-------	------------	-----	-------

Mix/Daily

✓	✓	✓	✓	✓	✓*	✓	✓	✓	✓	✓	✓	✓
---	---	---	---	---	----	---	---	---	---	---	---	---

Temperature °C Cold, 20, 30, 40 | Laundry Weight in Kg. 3.5

Spin Speed RPM 400–1200/No Final Spin | Favourite ✓

Cotton

✓	✓	✓	✓	✓	✓*	✓	✓	✓	✓	✓	✓	✓
---	---	---	---	---	----	---	---	---	---	---	---	---

Temperature °C Cold, 20, 30, 40, 40, 60**, 95

Laundry Weight in Kg. 10

Spin Speed RPM 400–1400/ No Final Spin | Favourite ✓

Synthetic

✓	✓	✓	✓	✓	✓*	✓	✓	✓	✓	✓	✓	✓
---	---	---	---	---	----	---	---	---	---	---	---	---

Temperature °C Cold, 20, 30, 40, 60 | Laundry Weight in Kg. 3.5

Spin Speed RPM 400–1200/No Final Spin | Favourite ✓

Anti Allergen

✗	✓	✓	✓	✓	✓*	✓	✓	✓	✓	✓	✓	✓
---	---	---	---	---	----	---	---	---	---	---	---	---

Temperature °C 40, 60, 95 | Laundry Weight in Kg. 3.0

Spin Speed RPM 400–1000/No Final Spin | Favourite ✓

Note 40E, 60E programs—some options are not available | ** Program setting for BEE test in conformity with IEC 60456 with 1400 Spin Speed selection settings.

✓ Option available for selection

✗ Option not available for selection

✓* Available by default and cannot be deselected

✓● Option available by default and can be deselected

Running Your Machine

Wash Guide Map

	PRE WASH	SOAK	ECO	TIME SAVER	ANTI CREASE	EXTRA RINSE	HOT RINSE	STEAM	AROMA	RINSE HOLD	DRY	DELAY
--	----------	------	-----	------------	-------------	-------------	-----------	-------	-------	------------	-----	-------

Baby Wear

✗	✓	✓	✓	✓	✓*	✓	✓	✓	✓	✓	✓	✓
---	---	---	---	---	----	---	---	---	---	---	---	---

Temperature °C Cold, 40, 60 | Laundry Weight in Kg. 3.0

Spin Speed RPM 400–800/No Final Spin | Favourite ✓

Bulky

✓	✓	✗	✓	✓*	✓	✗	✓	✗	✗	✓	✗	✓
---	---	---	---	----	---	---	---	---	---	---	---	---

Temperature °C Cold, 40, 60 | Laundry Weight in Kg. 2.0

Spin Speed RPM 400–800/No Final Spin | Favourite ✓

Tub Clean

✗	✗	✗	✗	✗	✗	✗	✗	✗	✗	✓	✗	✗
---	---	---	---	---	---	---	---	---	---	---	---	---

Temperature °C Cold, 60, 95 | Laundry Weight in Kg. ✗

Spin Speed RPM ✗ | Favourite ✓

To select the Drain cycle—

Select Spin & Dry program.
Deselect Aroma and Steam.
Set Spin Speed to 0 RPM.
Press the Start/Pause button to run the Drain cycle.

Note For 3.0 Kg Refresh, deselect the Time Saver option by pressing the Time Saver button on the control panel. For Spin and Dry, Rinse Hold is available only if Extra Rinse option is selected and no Final Spin is available only when all Dry options are de-selected. Program/Options available via My IFB mobile APP—Tub Clean/Eco/ Hot Rinse/Delay. Anticrease is not an option for user selection.

Note For proper drying, limit large items such as blankets, bath robes, towels etc to 1–2. During the drying process, if the program is interrupted by pressing the Start/Pause button, starting any other program will display 'Hot' on the display, provided the temperature inside the drum is above 50°C.



Option available
only via
My IFB APP.



Option
available for
selection



Option not
available for
selection



Option available
by default and can
be deselected

Running Your Machine

Drying Guide Map

	CUPBOARD DRY	ECO DRY *	TIME DRY	IRON DRY	GENTLE DRY	LAUNDRY WEIGHT in KG
--	--------------	-----------	----------	----------	------------	----------------------

Wash + Dry 2 Hr	×	×	✓	✓●	×	2.5
-----------------	---	---	---	----	---	-----

Spin Speed RPM 400–1200

Wash + Dry 4 Hr	✓	×	✓	✓●	✓	5.0
-----------------	---	---	---	----	---	-----

Spin Speed RPM 400–1200

Spin & Dry	✓	✓	✓	✓●	✓	6.5
------------	---	---	---	----	---	-----

Spin Speed RPM 400–1400

Refresh	×	×	✓●	×	×	1 1/3 items
---------	---	---	----	---	---	-------------------

Spin Speed RPM ×

PowerSteam®	×	×	✓	×	×	3.0
-------------	---	---	---	---	---	-----

Spin Speed RPM 400–800

Note For proper drying, limit large items such as blankets, bath robes, towels etc to 1–2. I During the drying process, if the program is interrupted by pressing the Start/Pause button, starting any other program will display 'Hot' on the display, provided the temperature inside the drum is above 50°C.



Option available only via My IFB APP.



Option available for selection



Option not available for selection



Option available by default and can be deselected

Running Your Machine

Drying Guide Map

	CUPBOARD DRY	ECO DRY *	TIME DRY	IRON DRY	GENTLE DRY	LAUNDRY WEIGHT in KG
--	--------------	-----------	----------	----------	------------	----------------------

Express 15'	×	×	✓	×	×	2.5
--------------------	---	---	---	---	---	-----

Spin Speed RPM 400–1200

Mix/Daily	✓	✓	✓	✓	✓	3.5
------------------	---	---	---	---	---	-----

Spin Speed RPM 400–1200

Cotton Cotton Eco	✓	✓	✓	✓	✓	6.5
------------------------------	---	---	---	---	---	-----

Spin Speed RPM 400–1400

Synthetic	✓	✓	✓	✓	✓	3.5
------------------	---	---	---	---	---	-----

Spin Speed RPM 400–1200

Anti Allergen	✓	✓	✓	✓	✓	3.0
----------------------	---	---	---	---	---	-----

Spin Speed RPM 400–1000

Note For proper drying, limit large items such as blankets, bath robes, towels etc to 1–2. | During the drying process, if the program is interrupted by pressing the Start/Pause button, starting any other program will display 'Hot' on the display, provided the temperature inside the drum is above 50°C.



Option available only via My IFB APP.



Option available for selection



Option not available for selection



Option available by default and can be deselected

Running Your Machine

Drying Guide Map

	CUPBOARD DRY	ECO DRY *	TIME DRY	IRON DRY	GENTLE DRY	LAUNDRY WEIGHT in KG
Baby Wear	✓	✓	✓	✓	✓	3.0

Spin Speed RPM 400–800

Note

With Cotton Eco 60** program, the actual wash temperature attained will be lower than 60°C, although the wash performance will be at par with the Cotton 60°C program.

The actual performance of the machine can vary based on a few factors like water pressure, water hardness, temperature, the amount and type of laundry, detergent used, and other conditions like foam or unbalance detection.

That's why the numbers mentioned in the user manual or with the machine might not always match with your experience, since they're tested in lab conditions.

Program time can also skip or extend due to above mentioned conditions.

Last run program is selected by default.

Machine automatically detects the weight of the laundry during the program and accordingly adjusts the Time/Rinse Water. Press and hold the Options button once during the program run to check the total number of wash cycles completed by the machine.

The design and specifications (includes colour, shades, aesthetics, features etc) are subject to change without prior notice due to continuous improvement and product development.

Note For proper drying, limit large items such as blankets, bath robes, towels etc to 1–2. I During the drying process, if the program is interrupted by pressing the Start/Pause button, starting any other program will display 'Hot' on the display, provided the temperature inside the drum is above 50°C.



Option available only via My IFB APP.



Option available for selection



Option not available for selection



Option available by default and can be deselected

Key Features

ADVANCED WASH TECHNOLOGY

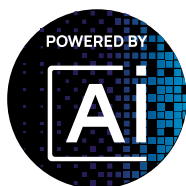

Powered by Ai

The intuitive sensing logic in the machine detects two parameters important for fabric care during cleaning—

- **Type of fabric** Cotton, Mixed or Synthetic
- **Weight of the fabric**

The Ai model, based on thousands of parameters, selects the optimised configuration suitable for the type of garment and its weight. Thus it helps in reducing the washing time and water consumption while ensuring the best care for your clothes without any manual intervention.

Note Available on selected models only.



9 Swirl

Powered by Ai

Swirl technology that gently cares for your clothes.



3D Wash

Jets of water and showers from the paddles completely soak the clothes. The water and detergent mixture is sprayed onto the clothes in a special mechanism for a better wash.

Running Your Machine

Key Features

ADVANCED WASH TECHNOLOGY

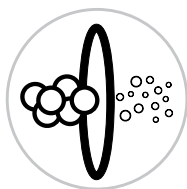

Aqua Energie

The technology that energises water to carry the detergent deep into the fabric.



CradleWash®

India's first wash program for the care of delicate fabrics.



Crescent Moon Drum

The crescent moon design of the drum allows the water to cushion the wash and protect the fabric.



BLDC Motor Technology

Experience quieter operations and an energy efficient wash with IFB SmartDrive Technology as compared to the conventional universal motor drive.



Hot Rinse

For effective and thorough rinsing.

Running Your Machine

Key Features

INTELLIGENT WASH PROGRAMS AND OPTIONS

More than 100 thoughtfully designed programs and options to give your clothes the ultimate wash experience.

Time, Energy, Water Saving

Eco
Express 15'
Time Saver

Fabric Friendly Wash

Cotton, Synthetic,
CradleWash®, Wool,
Mix/Daily

Hygienic Wash

Baby Wear, Tub Clean,
Anti Allergen, Hot Rinse

Customisable Modes

Bulky, Spin & Dry, PowerSteam®, Refresh,
Aroma

User Friendly Options

Pre Wash, Warm Soak, Temperature,
Extra Rinse, Steam, Rinse Hold, Spin Speed,
Delay Start, Hot Rinse

Key Features

MACHINE CARE

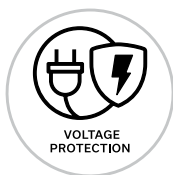

High-Low Voltage Protection

A microcontroller continuously monitors the voltage fluctuations and stops the program if it goes below $150 \pm 10V$ or rises above $270 \pm 10V$. The program will resume once the voltage is within a safe range.



Program Memory Backup

The program remembers where to pick up from when power is restored after failure, thus saving on time, water, and energy, while adding longevity to the machine.

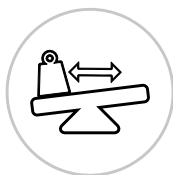

Auto Imbalance System

This system automatically balances the clothes inside to stabilise the spin cycle.



Drum Lamp

Drum Lamp provides light inside the drum, helping the user to load or unload the laundry when using the machine in darkness

Running Your Machine

Key Features

USER CONVENIENCE



Child Lock

Prevents children from tampering with the machine settings.



Laundry Add

Lets you add laundry even after the cycle has started.



Anti Crease

Reduces wrinkling of clothes for easy ironing.

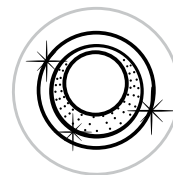

Auto Tub Clean

Automatically ensures tub hygiene after the wash.

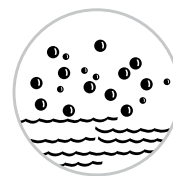

Auto Foam Control System

Auto detection and control of excess foaming.

Get More From Your Machine

Tips for best results

BEFORE WASHING



Empty all pockets. Remove everything including coins, keys, pins, notes etc.

Close all zips and fasten all hooks.

Check the wash care label and avoid non-machine washable items.



WHILE SORTING



Separate polyester fabrics from cotton.

Try to have a mix of large and small clothes in each load.

Wash dark clothes separately.



Get More From Your Machine

Tips for best results

WHILE LOADING



Load large items first.

Don't wash single items, add similar items.

Place small items in a laundry bag.

EASY TIPS TO REMOVE STAINS



Soak or pre wash the stained laundry in warm water.

Try to wash immediately after staining.

Understand the fabric, the nature of the stain and check the wash care label before treating it.

Start with cold or warm water as hot water can set the stain in.

Use fabric safe bleach if recommended.

Put the stained area face down on a paper towel or white cloth.

Apply the stain remover to the back of the stain so that the stain is forced out of the cloth.

SECTION

3

Get More From Your Machine

Stain Treatment



Get More From Your Machine

Stain Treatment

STAIN	TREATMENT
Chewing gum Adhesive Tape Rubber Cement	Use ice in a plastic bag to harden the gum. Scrape off what you can and then sponge with white spirits.
Blood	Rinse and soak immediately in cold water with an enzyme pre wash.
Chocolate Cocoa	Sponge with cold water and soak in enzyme pre wash. Rub in a little detergent and rinse in cold water.
Coffee	Rinse in cold water. Rub in detergent and wash in the maximum temperature allowed for the fabric.
Cream Milk Ice-cream	Rinse in cold water and wash normally. Sponge with white spirits.
Deodorant	Rub affected area with white vinegar and then rinse in cold water. Sponge with white spirits and then treat stiffened areas with an enzyme pre wash.
Egg	Soak in cold enzyme pre wash, rinse and wash.
Fabric Softener	Rub affected areas with bar soap and wash.

Get More From Your Machine

Stain Treatment

STAIN	TREATMENT
Fruit	Treat as soon as possible by sponging with cold water. Rub a little detergent on the stain and wash.
Grass	Sponge with white spirits. Rub in an enzyme pre wash and then wash.
Grease Oil	Sponge with white spirits or dry-cleaning fluid and then wash.
Iron Rust	Apply lemon juice and salt and place in the sun before washing.
Collars Cuffs Cosmetics	Pre-treat with a pre wash stain remover or rub with a bar soap. ^z
Mildew	Rub affected area with white vinegar and then rinse in cold water. Sponge with white spirits and then treat stiffened areas with an enzyme pre wash.
Mud	Brush off the mud and rinse in cold water. Rub a little detergent and wash.
Oil Paint	Scrape off any fresh paint. Sponge with a non-flammable dry cleaning fluid and wash.

Stain Treatment

STAIN	TREATMENT
Water Based Paint	Treat while still wet. Rinse in warm water and wash.
Scorch Marks	Dampen a cloth with hydrogen peroxide. Lay it over the affected area and press with a hot iron.
Ink	Some inks are impossible to remove. However, try using a pre wash stain remover, denatured alcohol or non-flammable dry cleaning fluid.
Nail Polish	Try applying nail polish remover to the back of the stain. Blot with paper towels and repeat. Don't use acetate fabrics. However, it may be impossible to remove in some cases.
Shoe Polish	Liquid Pre-treat with a paste of granular detergent and water. Paste Scrape the residue and pre-treat with a pre wash stain remover or non-flammable dry cleaning liquid. Apply detergent to the dampened area and wash using bleach safe for the fabric.
Candle Wax Crayon	Scrape off surface wax. Press with warm iron until wax is absorbed into a paper towel. Treat remaining stain with a pre wash stain remover or non-flammable dry cleaning fluid. Hand wash to remove solvent and wash using bleach safe for the fabric.

Maintenance and Cleaning

CLEANING THE DETERGENT DISPENSER DRAWER

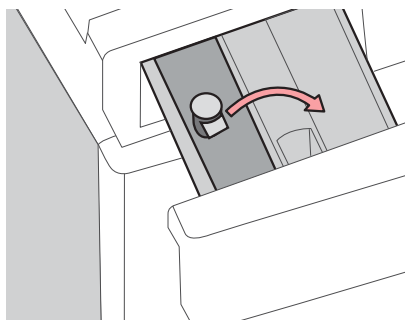

Remove detergent residue regularly.

Clean the detergent dispenser drawer with warm water.

Remove and clean the siphon under running warm water.

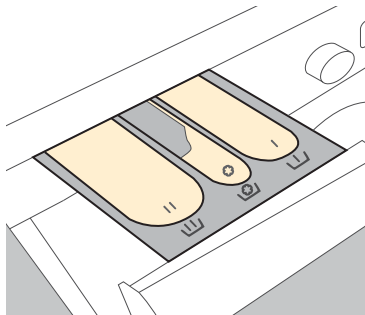

Detergent residue can build in the dispenser housing, clean it before reinstalling the dispenser.

Get More From Your Machine

Maintenance and Cleaning

CLEANING THE WATER HOSE MESH FILTER

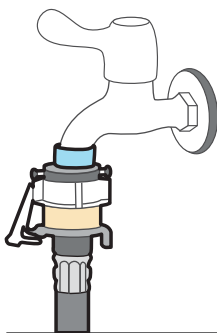

Turn OFF taps and disconnect the power supply to the machine.

Unscrew the inlet hose from the machine and tap the drain water from the hose.

Remove the filter mesh from the tap end of the inlet hose and clean under running water with a brush.

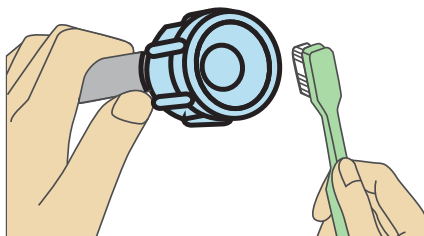

Pull out the sieve of the magnetic valve with a pair of flat nosed pliers.

Clean the sieve under running water with a brush.

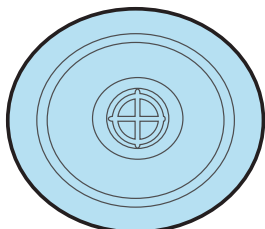

Fit the sieve back into the valve.

Screw the inlet hose back to the machine and the tap.

Turn ON the water tap to check if the connection is watertight.

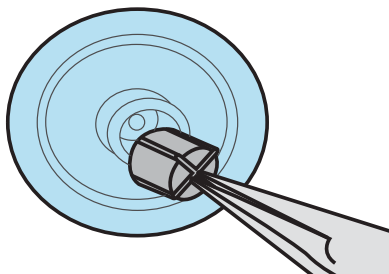

Note Dirt, sediments or sand in the water can affect both your wash quality and the water valve.

Get More From Your Machine

Maintenance and Cleaning

CLEANING THE FILTER

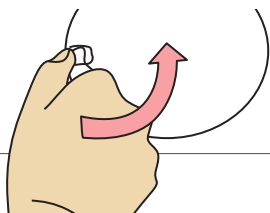

The filter should be cleaned frequently in order to increase the life of the drain pump.

Open the detachable bottom door with a coin or a key.

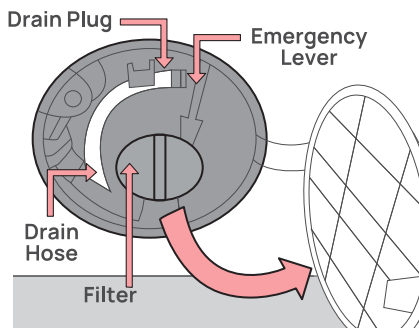

Place a shallow container near the bottom drawer.

Pull out the drain hose and open the drain plug.

Once the water is drained, turn the filter anti-clockwise to open it and take out any coins, pins, hooks, or other objects.

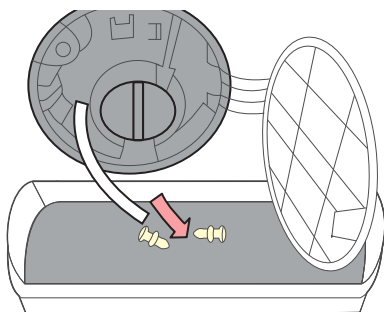

Tighten the filter and drain plug to their original positions, then close the bottom door.

Don't open the filter when a program is running.

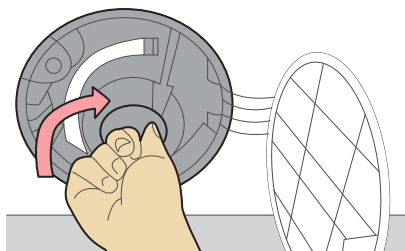

Get More From Your Machine

Maintenance and Cleaning

TUB CLEAN PROGRAM

This program helps eliminate impurities, scaling, bacteria and odours from the machine. Empty the drum before running the program .

TO RUN THE TUB CLEAN PROGRAM



Tub Clean program can only be selected via My IFB App. Display will show Tub for 1 sec, then clean for 1 sec and then Program Time for 1 sec.

The Spin & Dry LED will glow on the control panel.

The END message will be displayed once the program finishes.

Note If you don't often use high-temperature washing programs (above 60°C), it's a good idea to run the Tub Clean cycle once a month.

TUB CLEAN PROGRAM

The Tub Clean program reminder will appear in the app after every 40 wash cycles.

Run the Tub Clean program once you see the reminder.

Note Tub Clean reminder will be displayed for 5 wash cycles and then go OFF.

Get More From Your Machine

Maintenance and Cleaning

TUB CLEAN REMINDER

The Tub Clean Reminder will appear after every 40 washes. The display will show Run → tub → cln for 5 mins after the end of the wash program. You can select the Tub Clean program or start another program. The reminder will be displayed for the next 6 programs if the Tub Clean program is not selected. It is recommended to run the Tub Clean program after every 40 cycles to keep your washing machine clean.



Get More From Your Machine

Let's make washing easier.

Here is a list of clothes and their approximate weights to help you figure out a perfect wash load.

CLOTHING WEIGHTS

Bottoms

Lungi/Dhoti	200 g
Skirts	200 g
Trousers	250 g
Jeans	400 g

Tops

Cotton Shirts	280 g
Other Shirts	200 g
Cotton Blouses	140 g
Other Blouses	100 g
Woollen Sweaters	400 g
Heavy Sweaters	300 g
Light Sweaters	150 g

Other Clothes

Cotton Sarees	650 g
Synthetic Sarees	350 g
Bath Towels	600 g
Hand Towels	250 g
Pyjama Kurta	400 g
Panties	60 g
Cotton Vests	100 g
Underslips	100 g
Long Socks, 2 pairs	150 g
Short Socks, 2 pairs	85 g
6 Handkerchiefs	85 g
12 Napkins	1.1 Kg

Sheets

Cotton (Double)	1 Kg
Cotton (Single)	500 g
Non Cotton (Double)	650 g
Non Cotton (Single)	400 g

Pillow slips

Cotton Pillow Slips	110 g
Other Pillow Slips	85 g

Table Cloths

Small	230 g
Large	600 g
Table Napkins (4)	150 g

Bedspread

3 Kg

Blankets

Wool	2 Kg
Acrylic	1.5 Kg

Get More From Your Machine

This table may help you plan a laundry load of 6.5, 8.5 Kg.

LAUNDRY ITEMS	10 Kg	7.0 Kg	7.0 Kg
Bath Towels	2	2	2
Shirts	4	4	4
Blouses	2	2	2
Skirts	3	5	5
Pair of Pants	1	1	1
Pair of Jeans	2	3	3
T-shirts	3	3	3
Set of Pyjamas	4	4	4
Tea Towels	2	3	3

The chart indicates average weights of clothes. Make sure not to overload your machine beyond the recommended weight. This way, your clothes will get a thorough wash. Suggested weights are approximate and may vary.

Useful Information About Washing Machine

Troubleshooting

In case of machine malfunction, check the following points before contacting your service provider.

SYMPTOM	PROBABLE CAUSE	SOLUTION
LED Display is not lit.	Power supply switch is not turned ON.	Turn ON the power supply switch.
	Electrical power cord is not plugged in or is loose.	Plug the electrical power cord in securely and check.
	No program is selected.	You need to select a program.
Washing Machine Door is stuck and won't open.	Machine is in operation.	Ensure that the program isn't active. If active, pause the program and check the door symbol on display. The door cannot be opened mid-operation, due to high water level, temperature and speed.
	Opening the door is not possible.	Check if the machine is displaying the 'dL Er' message.
	Child Lock is active.	Disable the Child Lock and wait until the Door display glows.

If the problem persists, contact IFB Care.

Useful Information About Washing Machine

Troubleshooting

SYMPTOM	PROBABLE CAUSE	SOLUTION
Program does not start.	Start/Pause button is not pressed ON.	Press the Start/Pause button. The display will glow to indicate activity.
	Water supply faucet is not turned ON; there is no or low water pressure.	Turn ON the water faucet fully. Ensure that the water pressure is normal.
	Machine door is not securely closed.	Close the machine door properly.
	Pause/Soak or Rinse Hold mode is active.	Check the status of the programs on display and refer to the user manual.
Water is not supplied to the machine. Detergent is not flushed into the drum.	Water supply faucet is not turned ON; there is no or low water pressure.	Turn ON the water faucet fully. Ensure that the water pressure is normal.
	Machine door is not securely closed.	Close the machine door properly.
	Inlet hose is bent, sieve, inlet valve or the hose is clogged.	Straighten the inlet hose. Check; unclog the sieve, valve and hose.

If the problem persists, contact IFB Care.

Useful Information About Washing Machine

Troubleshooting

SYMPTOM	PROBABLE CAUSE	SOLUTION
Detergent dispenser is leaking suds. Excessive foam in drum. Detergent residue on clothes.	Unsuitable detergent is used.	Use detergents recommended for Front Load Washing Machines only.
	Excessive detergent is used.	Use less detergent.
	Machine is overloaded with clothes.	Do not overload the machine. Put fewer clothes per Wash.
	Cold Wash program is active.	Choose the Hot Wash program.
	Water pressure is low.	Ensure that the water pressure is optimum.
Water leakage in the machine.	Inlet hose connection is loose.	Check and tighten the inlet hose connection.
	Filter is not securely tightened.	Check and tighten the filter.
	Inlet hose is leaking.	Contact IFB Care.

If the problem persists, contact IFB Care.

Useful Information About Washing Machine

Troubleshooting

SYMPTOM	PROBABLE CAUSE	SOLUTION
Machine water is not draining.	Filter is clogged.	Clean the filter. Make sure that it is not clogged.
	Drain hose end is placed 1 m above floor level.	Measure 1 m from the ground level, place the drain hose end below the level.
	Drain hose is kinked or clogged.	Ensure that the drain hose is straight, clean and unclogged.
	Wash only machine washable door/bath mats in the washing machine. Washing of non-washable mats will cause lint/fibre build up. This may lead to drain pump clogging.	
Machine vibrates excessively during spinning.	Machine is not properly levelled.	Ensure that the machine is levelled properly.
	Filter is partially clogged.	Clean and ensure that the filter is unclogged.
	Load is unbalanced.	Add a few clothes to balance the load. Rearrange the load to allow proper spinning.

If the problem persists, contact IFB Care.

Useful Information About Washing Machine

Troubleshooting

SYMPTOM	PROBABLE CAUSE	SOLUTION
Machine is not spinning or clothes remain wet.	Load is too small, causing disbalance.	Add a few clothes to balance the load. Rearrange the load to allow proper spinning.
	Machine is overloaded with clothes.	Load clothes as per the fabric type and capacity recommended for the selected program. Reduce a few items.
	Spin Speed is set to 0 RPM or is too low.	Select a higher Spin Speed.
	Rinse Hold mode is active.	Select the Start/Pause button at Rinse Hold stage.
	Filter is clogged.	Clean and ensure that the filter is unclogged.
	Excessively foaming detergent is used.	Use detergents recommended for Front Load Washing Machines only.

If the problem persists, contact IFB Care.

Useful Information About Washing Machine

Troubleshooting

SYMPTOM	PROBABLE CAUSE	SOLUTION
Ineffective treatment of soiled clothes.	Detergent quantity is insufficient.	Use the recommended amount of detergent based on load size and hardness of water.
	Cold Wash program is active.	Opt for the Hot Wash program.
	Incorrect load size as per capacity.	Ensure that the load is within the capacity.
	Untreated stains on clothes.	Make sure to treat stains before washing. Scroll up to the 'Easy Tips to Remove Stains' section.
	Heavily and lightly soiled clothes are washed in the same load.	Wash heavily and lightly soiled clothes in separate washes.
Blue stains on clothes.	Excessive use of fabric additives.	Use only the required amount of fabric additives. Do not pour additives directly on the fabric.
	Additives of inferior quality being used.	Use good quality fabric additives.

If the problem persists, contact IFB Care.

Useful Information About Washing Machine

Troubleshooting

SYMPTOM	PROBABLE CAUSE	SOLUTION
Black or grey stains on clothes.	Detergent quantity insufficient as per hardness of water.	Use the recommended amount of detergent based on load size and hardness of water.
	Pre-existing stains on some clothes.	Separate stained clothes from the unsoiled ones.
Yellow or brown, rust-like stains.	The water supply for the wash is dirty.	Before washing—run the faucet to check if the water is clean. Wash only when the water is clean. To restore a discoloured load of whites use a rust remover safe for fabric.
Detergent residue left on clothes.	Overloading of clothes.	Do not overload the washing machine.
	Excessive use of detergent.	Use proper amount of detergent.
	Cold wash program.	Use hot wash program.
Buttons not working.	Button not pressed properly.	All the buttons are sensitive and need to be pressed softly.

If the problem persists, contact IFB Care.

Useful Information About Your Washing Machine

Troubleshooting

SYMPTOM

Motor noise. While in operation, it is normal for the motor to make some noise.

Pump noise. Unless the filter is clogged, it is normal for the pump to make some noise during the process of draining.
Anyway do check for filter clogging.

Program cycle time is delayed. It is normal for the program cycle time to be delayed based on factors such as type and quantity of laundry load, inlet water pressure and temperature, fluctuation in power supply etc.

Balance time on display remains unchanged. In case of a disbalance in load, the machine makes attempts to redistribute the clothes to minimise vibrations. This can extend the duration of the program.

If the problem persists, contact IFB Care.

Useful Information About Your Washing Machine

Display







THE LED DISPLAY GIVES YOU COMPLETE INFORMATION

- Program selection
- Wash/dry Option selection
- Balance time of the program
- Program status
- Problem/fault indications, if any
- Child Lock selection
- WiFi Status

Useful Information About Your Washing Machine

Display Messages & Error Codes

For any code displayed that is not present in the following list or if the suggested solution does not fix the problem, contact IFB Care or an authorised dealer.

DISPLAY	PROBABLE CAUSE	SOLUTION
	At the Rinse Hold step Touch Start/Pause button. This code will toggle.	Touch Start/Pause button or select Drain program.
	dLY—Code will be displayed during Delay Start mode.	
	door—Indicates that the door is not closed securely.	Close the door properly.
	dLE—Indicates that the washing machine door is stuck or jammed.	Switch OFF the washing machine and wait for 2 minutes before attempting to open the door again. Do not forcibly open the door. If the problem and/or the display persists, contact IFB Care
	dht/IntC/FAn	Press the Start/Pause button to pause or start the program. Switch OFF the machine by pressing the Power button and wait for 2 secs, then restart. If the error persists, switch OFF the washing machine and contact IFB Care.



Useful Information About Your Washing Machine

Display Messages & Error Codes

DISPLAY	PROBABLE CAUSE	SOLUTION
tAP	tAP—Water supply tap is turned OFF.	Ensure that the Water supply tap is turned ON.
	tAP—Water supply is unavailable or water pressure is insufficient.	Operations will restart when water supply is available/normal.
	tAP—Sieve or filter in inlet hose is clogged.	Clean and unclog the sieve/filter. (Refer to 'Cleaning the water hose mesh filter' section).
	tAP—Water inlet hose is bent/damaged.	Remove and replace the bent/damaged water inlet hose.
E1	EI E2AndE3—Indicates that clothes are trapped between the door and drum area.	Switch OFF the washing machine and run the drain program. After the water drains out, rearrange the clothes and restart the wash program. If the problem and/or the display persists, contact IFB Care.
E2AndE3		





Useful Information About Your Washing Machine

Display Messages & Error Codes

DISPLAY	PROBABLE CAUSE	SOLUTION
	dP—Water not drained.	Touch Start/Pause button to restart the Drain program.
	Filter is blocked.	Switch OFF the appliance, drain out the water using the drain pump and then clean the filter.
	Exhaust hose clogged/bent.	Clean exhaust hose/remove bend.
	HOt—Water temp is above 60 °C at the start of the program.	<p>Start new/Drain program once the water cools down to approximately 60 °C.</p> <p>Switch OFF the washing machine, wait for 2 secs and restart.</p>
	HI → 270— Input voltage is high.	Machine will start automatically after the voltage decreases to a safe operating level. If this error display persists/occurs frequently, contact your electrician to locate the fault in the electrical system.

Useful Information About Your Washing Machine

Display Messages & Error Codes

DISPLAY	PROBABLE CAUSE	SOLUTION
	COnn	Switch OFF the appliance and wait for 2 minutes before restarting. If the problem and/or the display persists, contact IFB Care.
	Lo → 150—Input voltage is low	Machine will start automatically after the voltage increases to safe operating level. If this error display persists/occurs frequently, contact your electrician to locate the fault in the electrical system.
	UnbL—Indicates that the laundry load is not balanced.	If the laundry load is small, it can cause disbalance in the drum and operations. Add a few clothes to balance and rearrange to allow proper functioning.
 	OFL PrS	Switch OFF the washing machine, wait for 2 secs and restart. If the same message appears again, turn OFF the tap, switch OFF the appliance and contact IFB Care.

For further assistance please download My IFB App for service registrations or you call us on our call centre number

08045845678/ 080 695 45678

Useful Information About Your Washing Machine





Technical Specifications

MODEL	Executive Plus ZXS/ZXM/ZXB/ZXV 10/7.0/3.0 Kg 1400RPM
POWER SUPPLY	220–240 V Single Phase 50 Hz
DIMENSIONS	59.8 X 62.3 X 85.8
Net Size WxDxH	59.8 x 61.8 x 87.5 (8 Kg)
NEW WEIGHT	75 Kg
CAPACITY	3.0 Kg of Dry Cotton 7.0 Kg of Dry Cotton 10 Kg of Dry Cotton
WASH CARE PROGRAMS	14 (> 100 with options)
SELECTOR BUTTONS	Spin Speed, Aroma, Time Saver, Time Dry, Temperature, Dry, WiFi, Extra Rinse, Steam, Options, Start/Pause, Power ON/OFF
SELECTOR KNOB	Program Selector
SPIN SPEED	400-1400 RPM or Spin Cancel
WATER CONSUMPTION	≤ 9 Ltr/Kg/cycle (Program setting for BEE test in conformity with IEC 60456)
WATER PRESSURE	0.3 Bar – 10 Bar (3.5–10 Ltr/min)
MAXIMUM POWER CONSUMPTION	Refer to the product label
DRAIN PUMP RATING	30 W
HEATER RATING	2000 W
DRUM	Stainless Steel

TRUSTED BY OVER
9 MILLION
CUSTOMERS



+91 080 458 45678/080 695 45678

     +91 92310 04321

www.ifbappliances.com