

Senator Smart Touch 8.5 KG
1400RPM
Executive Smart Touch WMS/SXS
9014
User Manual

IFB
Set Yourself Free

OVER **6 MILLION** SATISFIED CUSTOMERS



UF421PKMAN293

A

www.ifb.co.in | June 2022

Shop 24x7 @ www.ifbappliances.com | Email customerservice@ifbglobal.com | Call 08045845678
www.facebook.com/IFBappliances twitter.com/IFBappliances www.instagram.com/ifbappliances/
www.youtube.com/channel/UCJTIHxPTfez4mrbVBIQLb9Q



Read instructions before switching on the washing machine. Observe safety guidelines for installation.





Welcome to the IFB family.

India's best fully automatic washing machine is now at your service.
Here's to your freedom!

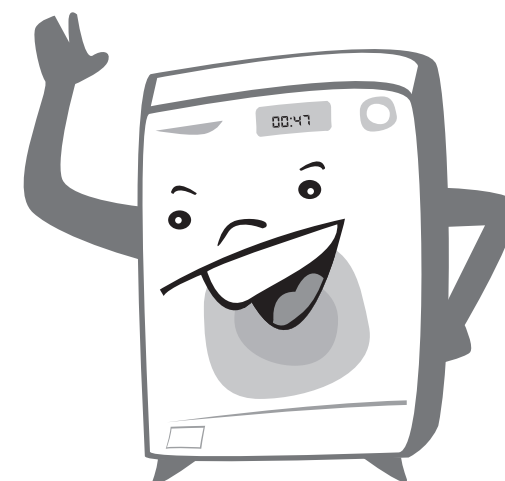

The A to Z of your washing machine

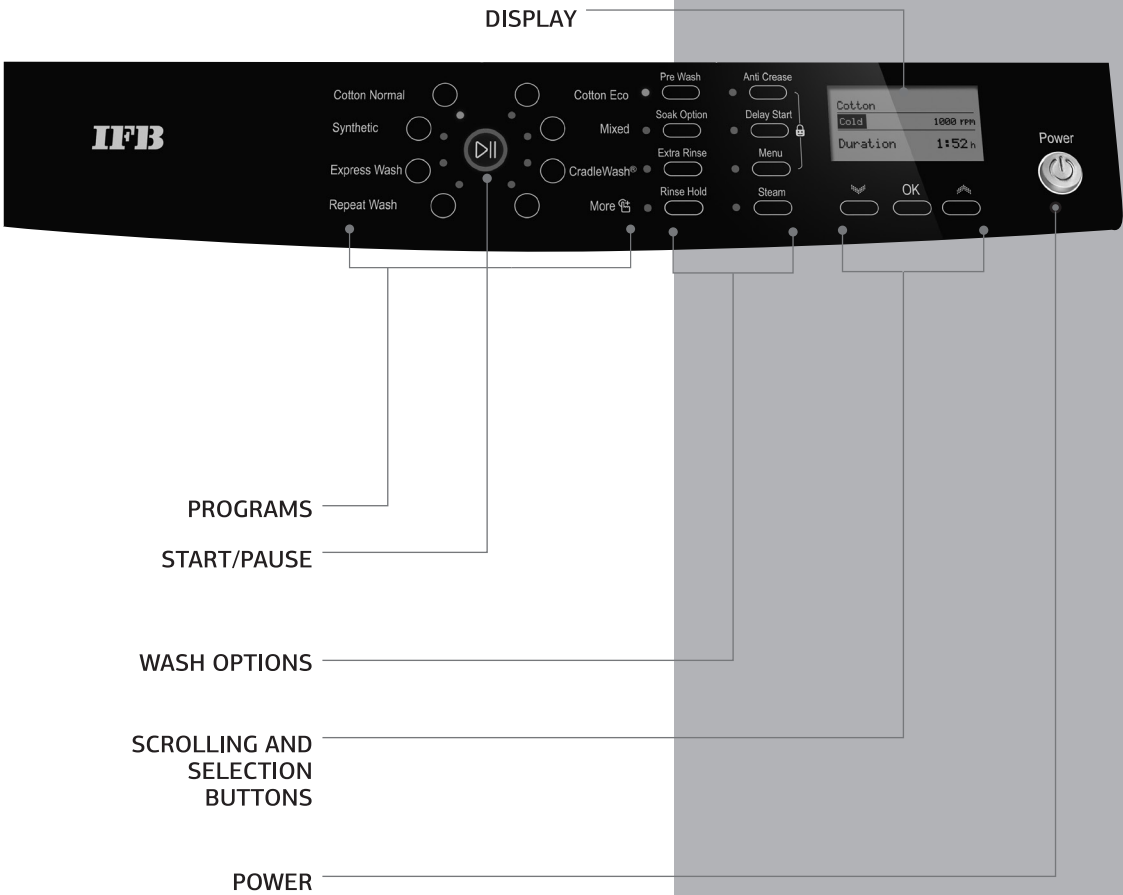



Safety guidelines for installation

- Keep the packaging material. It may come in handy when shifting residence.
- Old hoses must not be reused. Always use the new hoses delivered with the machine.
- Before cleaning the machine, ensure you disconnect the main electricity supply and take the plug off the socket.
- Not removing all the packaging and transit bolts before using the appliance may lead to serious damage. Please do not operate the machine until the transit bolts have been removed.
- All washing machine installation work must be carried out only by authorised IFB Care Service Personnel.
- Pre-installation work such as plumbing and electrical connections must be carried out by a qualified fitter, electrician or technician.
- Do not operate the appliance where inflammable substances such as oil, benzene or highly inflammable gas are present. Such materials may cause fire or explosions. Never use combustible detergents.
- Do not install your washing machine in rooms where temperatures below freezing may occur. Frozen hoses may burst under pressure. The reliability of the electronic control unit may be impaired at temperatures below freezing point and above 50°C.
- Install the machine in a room with adequate ventilation. Avoid a room with no windows. The back of the machine should be at least 4 inches (100 mm) away from the wall.
- The machine is provided with ventilating openings on the base. Always put the machine on the floor after removing the carpet.
- Do not install the machine in a damp area or bathroom with exposure to a direct shower.
- Protect the machine from direct sunlight and rainfall.



- Do not place the machine on a slanting, uneven or unstable surface.
- A concrete floor is the most suitable installation surface for a washing machine, being far less prone to vibration during the spin cycle than wooden floorboards.
- The washing machine is not suitable for connection to a hot water supply.
- The machine is designed to operate with water flow pressure between 0.3 Bar–10 Bar. Lower water pressure can lead to malfunction of your machine.



Safety instructions

Read all instructions and explanations for installation carefully before use.
Follow the instructions carefully. Keep the operating instructions handy for later use.

Any damage, which may be caused by cockroaches or other vermin, will not be covered by the appliance guarantee.

- Do not install and use a damaged machine. Before connecting the machine, ensure that the connection data on the data plate (fusing, voltage and frequency) match the main electricity supply. If in any doubt, consult IFB Care.
- Do not wash or dry articles that have been cleaned, washed, soaked in or dabbed with combustible or explosive substances (such as oil, paint, gasoline, degreasers, dry cleaning solvents, kerosene etc). This may result in fire or explosions.
- Before using the machine for the first time, check that the transit bolt at the rear of the machine has been removed (see section on installation).
- Turn OFF the stopcock if the machine is to be left for any length of time (eg holiday) especially if there is no floor drain (gully) in the immediate vicinity.
- This appliance can be used by children aged 8 years and above and persons with reduced physical, sensory or mental capabilities or lack of experience and knowledge if they have been given supervision or instructions concerning the use of the appliance in a safe way and understand the hazards involved.
- Children should not play with the appliance.
- Cleaning and user maintenance should not be performed by children without supervision.



Caution

- The electrical safety of this appliance can only be guaranteed when continuity is complete between the machine and an effective earthing system, which complies with local and national regulations. It is most important that a qualified electrician regularly tests this basic safety requirement. The manufacturer cannot be held responsible for the consequences of an inadequate earthing system.
- For safety reasons do not operate this appliance on an extension cable. Extension leads do not guarantee the required safety of the appliance.
- There is danger of overheating.
- The machine is built in accordance with current safety requirements.
- Unauthorised repairs could result in unforeseen dangers for the user, for which the manufacturer cannot accept responsibility. Only authorised IFB Care Service Personnel should undertake repairs.
- The machine is completely isolated from the electricity supply only when it is switched OFF at the wall socket and the plug is taken out, or it is switched OFF from the main source, or the main fuse is taken out or MCB switched OFF.
- This machine must only be connected to the onsite water supply using a new hose kit. Old hoses must not be reused. Only genuine IFB original spare parts should replace faulty components. Only when these parts are fitted can the safety standards of the machine be guaranteed.
- If the connection cable is faulty, it must be replaced only by an IFB approved service technician to protect the user from danger.
- A washer and dryer should never be stacked without using the proper stacking kit. Doing so is extremely dangerous, as the dryer may vibrate off the washing machine during use.



About eWaste

eWaste or Electronic Waste or Waste Electrical and Electronic Equipment (WEEE) are the terms used to describe old, end-of-life or discarded appliances using electricity.

Dos

- Always dispose of products that have reached end-of-life by calling an authorised local eWaste recycler.
- Always drop off used electronic products, batteries or accessories at your nearest authorised eWaste recycler when they reach end-of-life.
- Whenever possible, or as instructed, sort packaging materials according to responsible waste disposal and recycling options.

Don'ts

- Do not dismantle electronic products on your own.
- Do not throw electronic products in bins with a 'Do Not Dispose' sign.
- Do not give eWaste to informal and unorganised sectors such as local scrap dealers and rag pickers.
- Do not dispose of your product in garbage bins along with municipal waste that ultimately reaches landfills.

- Do not pull the cord to disconnect the plug. Hold the plug itself. Do not insert or remove the plug with damp hands.
- Do not drag the washing machine if it contains the wash load or when in operation.
- Do not move the washing machine if it contains the wash load or when in operation.
- Do not spill water over the machine. In case of spillage, wipe dry. Avoid the machine coming in contact with floor cleaning chemicals.
- Do not wash or spray water over the switch or control panel.
- Do not wash shoes or utensils in the machine.
- Use detergent recommended for the washing machine.
- Keep your machine dry to avoid corrosion/rusting. Take special care to wipe the machine after cleaning coin trap.
- Check the labels on garments for the determining conditions under which fabrics are to be washed.
- The machine is tested with water during assembly for performance checking. Condensed droplets of water may remain inside the drum. It is advisable to run the machine without a wash load in the Cotton maximum temperature program with detergent for the first time after installation.
- Ensure that the machine is connected to a 3 pin socket with good earthing and 16 Amp MCB or other automatic short circuit protection devices.
- Textiles that have been pre-treated in solvent based cleaning agents must be thoroughly rinsed in clean water before being washed in the machine.
- Never use solvent based cleaning agents in this machine, as this may result in damage to component parts and create toxic fumes. Such detergents also pose a threat of fire and explosion hazards.
- If excessive vibrations are observed on the trolley, then the trolley needs to be replaced immediately, as it can affect reliability of the machine thereby reducing the machine life.

Risks of Improper Handling of eWaste

eWaste usually includes components which, if disposed of improperly, hold environmental consequences such as air, water and soil pollution and also pose risks to human health.

By ensuring this product is disposed of correctly, you will help prevent potential negative consequences for the environment and human health. Components and materials used in the manufacture of this washing machine are fully compliant with provisions of hazardous substances outlined in eWaste Management Rules, 2016.

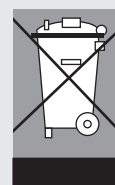

For Detailed Information and Disposal Request

Contact IFB Care at 08045845678 and provide your details to our representative to request your product to be picked up for disposal.



- Only use dyes specified by the manufacturer as being suitable for use in a domestic washing machine. Always read the manufacturer's instructions carefully.
- Colour runs and dye removers contain sulphur compounds, which can cause damage such as corrosion. Do not use these products in this machine.
- For machines with a porthole door, remember that the porthole glass will be hot when washing at very high temperatures. Do not let children touch it.
- Always make sure that the drum is stationary before removing clothes. Reaching into a moving drum is extremely dangerous.

Flooding danger

- While hooking the drain hose into a wash basin, check that the water drains OFF quickly to prevent the sink from overflowing. Make sure the drain hose is secure so that the force of the water flowing out of the hose does not dislodge it. Otherwise, this will result in flooding.
- Take care to ensure that foreign objects (eg nails, pins, coins, paper clips etc) do not find their way into the machine with the washing. These may damage components of the machine (eg suds container, drum etc), which in turn can result in damage to the washing.

Contents

- Safety guidelines
- Safety instructions

Chapter 1: Getting started with your machine

- Installing your machine
- Before you start

Chapter 2: Working your machine

- 6 easy steps to do your laundry
- Finishing
- Wash guide map
- Wash features

Chapter 3: Get more from your machine

- Tips for best results
- Maintenance and cleaning

Chapter 4: Useful information

- Troubleshooting
- Display
- Technical specifications
- Service record
- Warranty

PAGE
04
06

12
14

17
32
36
38

42
46

50
54
59
63
65

Warning Electrical safety of this appliance can only be guaranteed when continuity is complete between it and an effective earthing system which complies with local and national safety regulations. It is important that this basic requirement is present and regularly tested. When there is any doubt, the onsite wiring system should be inspected by a qualified electrician. IFB cannot be held liable for consequences of an inadequate earthing system (eg electric shock etc).



Precautions This appliance conforms to safety requirements. Inappropriate use can lead to injury or damage to property. Please read this manual carefully. It contains information on safety, installation, use and maintenance.

Use only less foaming detergents in this machine to avoid inconvenience or damage. It will help you to use your new washing machine optimally and avoid accidents or damage to appliance.

1

Getting started with your machine

Installing your machine & safety guidelines

1 Select the right spot

Unpack and place the new washing machine in proximity to both water and electrical connections. Ensure that the floor is properly levelled.

2 Removing the transit bolts

- Use a spanner to remove the transit bolts.
- Insert plastic caps provided.
- Keep the transit bolts carefully as they will be required in case you need to shift the machine again.
- Please do not operate the machine until the transit bolts have been removed.

3 Levelling

- Level the machine by using the adjustable screws provided at the bottom for levelling.
- Make sure that the machine rests on all four feet on a level surface.



4 Connection to the water supply

- The water inlet of the machine has a collar with parallel internal threads.
- The water supply point with an external thread/parallel thread should be available within 1 metre of the machine location.
- Do not stretch the water supply hose.

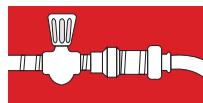

5 Connection to the drain hose

- The machine drains via a drain pump.
- Direct the end of the drain hose into a sink or a basin.
- The drain hose can be placed directly on the floor or can be extended and placed over the sink to a maximum height of 1 metre from the floor.

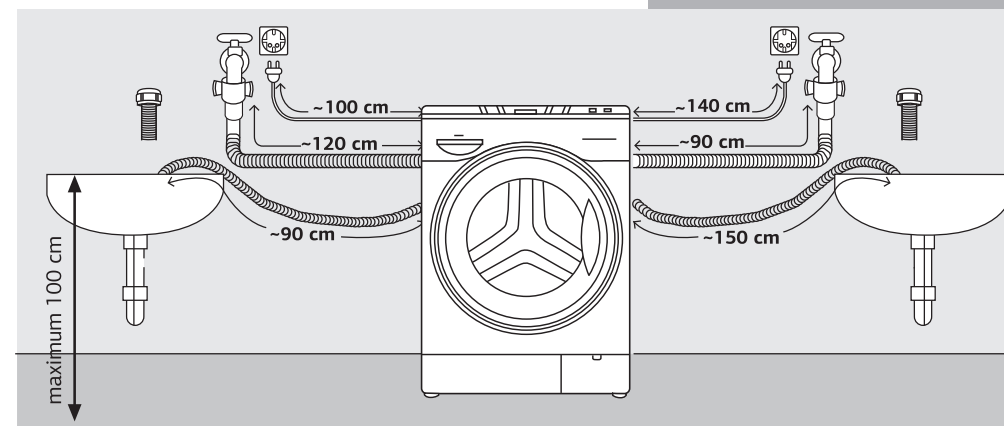

6 Electrical connection

- It is mandatory to have a 16 Amp, 3 pin 220–240 V AC, 50 Hz electrical point with a 16 Amp MCB or automatic short circuit protection device within 1 metre of the machine.
- Make sure your home has proper earthing and there is a firm connection between the plug and the socket. IFB recommends a separate MCB on the socket of the washing machine.
- Proper earthing of the power socket is critical to reliable performance.

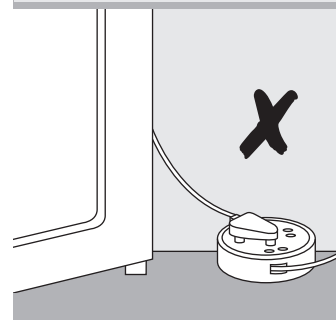
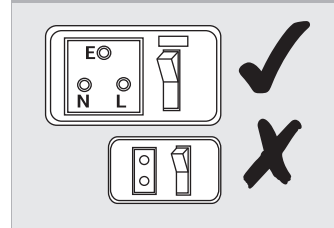

Before you start

Check your machine

Ensure that the washing machine has been installed and connected properly.

- **Electrical connection**

It is mandatory to have a 16 Amp, 3 pin 220–240 V AC, 50 Hz electrical point with a 16 Amp MCB or automatic short circuit protection device.

- **Water connection**

A water supply point with an external 3/4" parallel thread should be available within 1 metre of the machine location. Turn ON the water tap after the connection is secure.

- **Drain water hose**

Direct the end of the drain hose onto the floor or into a sink or basin, up to a maximum height of 1 metre. Hook the hose over the edge of the basin and secure it.

Your machine was tested before leaving the factory.

To remove any water left over from testing procedures, the first wash cycle should be carried out without laundry in the washing machine.

- Turn ON the water tap.
- Pull out the detergent dispenser drawer completely.
- Pour approximately 20 grams of detergent into the detergent dispenser drawer.
- Close the detergent dispenser drawer.
- Set Cotton program with maximum temperature.
- Touch the Start/Pause button.
- When the End message is displayed turn OFF the machine.

Understanding the user interface



1 Program selection buttons with indicator lights

To select a program, touch the specific button.

2 Start/Pause button ▶||

This is used to start or pause the selected program.

3 Wash option buttons with indicator lights

To add various options to your washing program, touch the specific option button.

4 Display with OK, ^ and v buttons

- To operate the display use the OK, ^ and v buttons.
- Touch the v button to decrease the value highlighted in the display or to move down to the next step.
- Touch the ^ button to increase the value highlighted in the display or to move up to the next step.
- Touch the OK button to select the value highlighted in the display.

5 Power button ⏻

This is used to switch the machine ON or OFF.

1

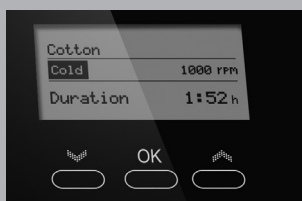
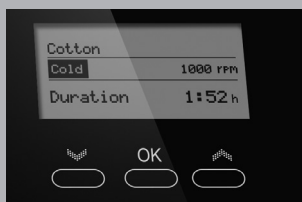
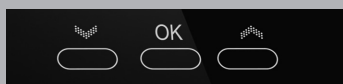

Using program selection

To increase or decrease the highlighted text

- Touch the **▲** button to increase or the **▼** button to decrease the highlighted text.

Multiple option selection

- When an option is selected a tick ☒ will be displayed beside it. Touch the **▲** and **▼** buttons to scroll through the options in the display. Touch OK to select the highlighted option. You can now select the next option if you wish.

Single option selection

- When an option is selected a tick ☒ will be displayed beside it. The other options are deselected automatically. Touch the **▲** and **▼** buttons to scroll through the options in the display. Touch OK to select the highlighted option.

To come out of a sub-menu

- Touch OK when Back **⏮** is highlighted to come out of the sub-menu or wait for 10 secs and the display will return to the program menu automatically.

Note If the **⏮** or **⏭** buttons are touched for longer, the options menus/settings for More Programs, More Options, Settings, Delay Start and Soak will run through automatically.

2

Working your machine

6 easy steps to do your laundry

1 Sort the laundry

- Remove everything from pockets.
- Close zippers, hooks and strings.
- Pre treat collars, cuffs and stains.
- Sort the laundry.
- Check for wash care symbols/labels.

2 Load the laundry

- Check and remove any small articles or any laundry items left inside the drum or on rubber gasket.
- Place garments loosely inside the drum.
- Load garments one by one.
- Close the door and press till you hear a click.

3 Add detergent

- Pull out the detergent dispenser drawer completely.
- Dispense the correct amount of detergent.
- Close the detergent dispenser drawer.
- For heavily soiled clothes use Pre Wash 'I' option and add detergent.
- 'II' to be used for every wash program.
- to be used to dispense additives. Use the fabric conditioner additives chamber and take care not to exceed the maximum level.
- If liquid detergent is used, please insert the liquid detergent dispenser supplied into the main wash chamber. This ensures that the liquid enters the drum at the right stage of the wash cycle.

***Note** Always use detergents recommended for front load washing machines. Follow the detergent package directions as using too little or excessive detergent is a common cause of laundry problems. Soap flakes or granulated soap powders should not be used in your washing machine. When washing woollens or silk, remember to use the detergent type recommended by the manufacturer.

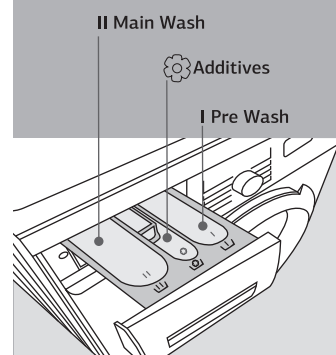

Liquid Detergent Dispenser

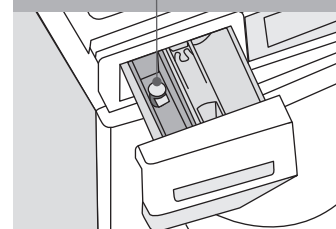



Select program

- Switch the machine ON.
- Select the required program by touching the corresponding button. Start/Pause LED will flash.
- For more programs, press the More Program button and use the **▲** or **▼** buttons to scroll through program list until the one you want is highlighted. Select it by touching OK. The program selected will appear in the display.
- Choose wash option/additional option.
- To change/cancel the program during the machine run, press the Power button and wait for 2 secs. Then select a new program.



Important Additional Wash Options solve specific wash problems to give you more freedom. Select as needed.

PROGRAM	TYPE OF LAUNDRY
Cotton/Cotton Eco Plus	Cotton colour fast garments such as shirts, pants, uniforms, bed and table linen, towels, night dresses, pyjamas, underwear etc.
Synthetic/Daily	Daily wear garments made of polyester, acrylic or polyamide.
Mixed	Various types of cotton, synthetic or easy care garments except special garments such as silk/delicates, dark clothes, wool, duvet, curtains etc.
CradleWash®	Hand wash only delicates, washable fabrics made of silk (lingerie), satin, synthetic or sheer fabrics.
Woollens	Machine washable wool garments only, A neutral wool wash detergent is recommended.
Express Wash	Lightly soiled coloured laundry made of cotton, linen, synthetic or blended fabrics.
Bulky/Bedding	Machine washable curtains made of cotton and easy care fabrics. Washes large items such as blankets, bedding covers, sofa covers, pillow covers and bedspreads.
Baby Wear	Baby care items such as babies' clothes, underwear, cloth diapers, pillows, bed sheets etc. This program will have high temperature wash and extra rinses to ensure better rinse performance.
Anti Allergen	Cotton and linen fabrics in direct contact with skin such as bed linen, pillows, underwear, nappies, towels etc.

Select wash options

Wash options are selected or deselected by touching the appropriate button.

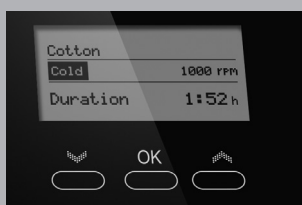

Pre Wash

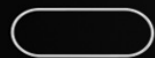

Temperature/Spin Speed

- You can change the default temperature and/or spin speed within a given range.
- Touch the ▲ and ▼ buttons to change the temperature.
- The temperature selection sequence will be Cold, 30°C, 40°C, 50°C, 60°C, 75°C, 95°C.
- Touch the OK button to select the temperature and also to switch to spin speed selection.
- Touch the ▲ and ▼ buttons to change the spin speed.
- The spin 400RPM, 600RPM, 800RPM, 1000RPM, 1200RPM and 1400RPM.
- Touch the OK button to select spin speed and to switch to temperature selection.
- Touching the OK button will toggle between the temperature and spin speed.

Pre Wash

- If Pre Wash option is selected, the clothes are given a preliminary wash before the main wash.
- Touch the Pre Wash button on the control panel to activate and deactivate the Pre Wash option.
- The corresponding LED will glow to show the option has been selected along with the Pre Wash Activated message.
- Touch the same button to deselect the Pre Wash option. Pre Wash Deactivated will be displayed.
- You can change other settings or touch Start/Pause to start the program.

Soak

- Soaks clothes in soapy water for a calculated amount of time to dislodge dirt particles from the clothes during the main wash cycle. After this, it automatically continues with the normal cycle.
- During soaking, clothes will remain stationary for about 10 minutes to 8 hours based on your requirement.
- Touch Soak button on the control panel to activate and deactivate soak option.
- Touch the ▲ and ▼ buttons to change the highlighted soak timing till the desired timing is displayed.
- Touch OK to confirm the highlighted option.
- You can change other settings or touch Start/Pause to start the program.
- Soaking for a long duration is not advisable for coloured garments since they are likely to bleed colour.

Extra Rinse

- An additional rinse cycle is executed to remove any leftover detergent on the clothes to give a better feel to the fabric. A maximum of 2 additional rinses can be selected.
- Touch the Extra Rinse button on the control panel to activate and deactivate Extra Rinse option.
- Touch the ▲ and ▼ buttons till the desired rinse cycle—No/Add 1 rinse/Add 2 rinse is highlighted. The option selected has a ✓ tick beside it.
- If not required, touch the back option when highlighted.
- Touch OK to confirm the highlighted option.
- You can change the other settings or touch Start/Pause to start the program.

Soak Option



Extra Rinse



Rinse Hold

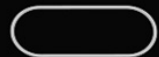

Rinse Hold

- Rinse Hold pauses the program during its final rinse. If clothes are left unattended after the final spin for a long time it will cause creasing. During Rinse Hold clothes will remain stationary in water after additives rinse. The **Rinse Hold** indicator will flash along with a buzzer beep. The program will remain on hold for the user to either select the Drain program or touch **Start/Pause**.
- Touch the Rinse Hold button to activate and deactivate the Rinse Hold option.
- You can change the other settings or touch **Start/Pause** to start the program.

Steam

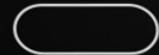

Steam

- If the Steam Wash option is selected, steam is injected inside the drum at the most effective time to enhance the effect of steam.
- Touch the Steam Wash button to activate or deactivate the Steam Wash option.
- You can change the other settings or touch the **Start/Pause** button to start the program.

Note

- Cotton Normal, Cotton Eco, Synthetic, Mixed, Baby Wear, Uniform, Jeans, Cotton Whites, Daily Wash, Soft Toys, Shirts, Hygiene, Duvet, Refresh and Sanitise programs. Do not use Steam Wash with Delicates, Wool, Silk or fabric that may run colour.
 - It is normal that steam may not be visible during the wash/steam cycle.
- Do not touch the door during the steam cycle, it can be very hot.
- Do not attempt to open the door forcibly or reach into the drum during the steam cycle. This may lead to severe burns.

Delay Start

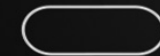

Delay Start

- With Delay Start you can select when your program completes. The start of the program can be delayed from 15 minutes up to a maximum of 24 hours.
- The current time of day needs to have been set for Delay Start to work correctly.

To select Delay Start

- Touch the Delay Start button after the required program has been selected.
- Touch the **▲** and **▼** buttons to select the time you want the program to end.
- The first touch on the button will adjust the program end time to the next 15, 30, 45 minutes or full hour. Each subsequent press of the button will delay the program finish time by 15 minutes.
- Confirm the program end time by touching **OK**.
- The display will show the time remaining until the start of the program.

The program end time may vary owing to water pressure, power conditions, load conditions etc.

Anti Crease

- If this option is chosen, the drum and clothes will tumble in both directions after the final spin. This helps in reducing creasing. Using a lower spin speed also helps in reducing creasing.
- Touch the Anti Crease button to activate or deactivate the Anti Crease option.
- Touch the **▲** and **▼** buttons till the desired Anti Crease cycle—**No/Quick/Extended** is highlighted. The option set will have a **✓** beside it.
- Touch **OK** to confirm the highlighted option.
- You can change the other settings or touch **Start/Pause** button to start the program.

Anti Crease

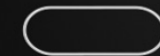

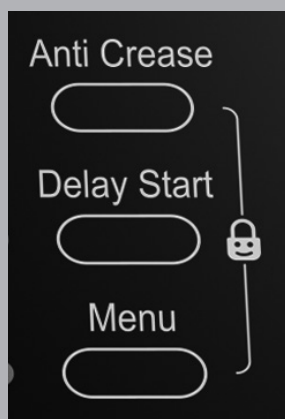

Child Lock

- You can safeguard your washing machine to prevent any unintentional changes to the selected options and program sequence by activating the Child Lock.
- The Child Lock option can be activated only by starting the program.
- Touch the Anti Crease and Menu button to activate the Child Lock.

If Child Lock has been activated

- No changes can be made while the program is running.
- If the appliance is switched OFF and then back ON while a program is running, the program will continue from the point at which it was interrupted.
- The door will remain locked at the end of the program.
- You can disable the Child Lock by touching the Anti Crease and Menu buttons simultaneously for 2 seconds, till the Child Lock indicator goes OFF.

Menu

Touch Menu button to select more options or settings. Touch the ▲ and ▼ buttons to select the appropriate option you want to select.

More options

To select more options touch the Menu button on the control panel. **More Options** and **Settings** will be displayed on the LCD display. Select more options by using the buttons and touch **OK** to select the desired option. More options such as Soilage/Dirt, Stains, Water Plus, Pet Hair, Quiet Wash, Rapid Wash can be selected or deselected by touching the ▲, ▼ and **OK** buttons.

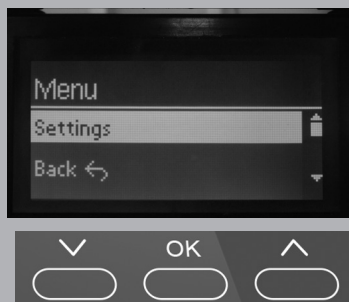

Soilage/Dirt

- Extends the washing time for intensive washing of heavily soiled items.
- Settings for **Light**, **Normal**, **Heavy** soilage are available.
- Touch the ▲ and ▼ buttons until the degree of soilage is displayed.
- Touch **OK** to confirm the highlighted option.
- The selected option will have a ✓ tick beside it.
- You can change the other settings or touch the **Start/Pause** button to start the program.

Stains

- Choose from a menu of 12 different types of stains. A special sequence of the wash program runs for each type of stain. The stain can be selected based on your needs.
- The stain selection sequence will be **Baby Food, Oil, Blood, Chocolate, Sweat, Mud & Sand, Tomato, Coffee, Egg, Tea, Cosmetics, Red Wine, Back ↶, No stains and repeat.**
- Touch the ▲ and ▼ buttons until the desired stain program is displayed.
- Touch **OK** to confirm the highlighted option.
- The selected option will display a ✓ tick beside it.
- You can change the other settings or touch the **Start/Pause** button to start the program.





Water Plus

- When selected, this option will increase the water level for the preselected programs, either during wash or during rinse or both.
- Touch the **▲** and **▼** buttons until the desired option is highlighted.
- Touch **OK** to confirm the highlighted option.
- The selected option will display a **✓** tick beside it.



Pet Hair

- This option removes pet hair from clothes during the wash cycle.
- Touch the **▲** and **▼** buttons until the desired option is highlighted.
- In this option the washing machine adds Pre Wash and an additional rinse cycle to the selected program.
- Touch **OK** to confirm the highlighted option.
- The selected option will display a **✓** tick beside it.



Quiet Wash

- When this option is selected, the buzzer will not beep during the program and the spin speed will be reduced.
- Touch the **▲** and **▼** buttons to highlight the desired option.
- Touch **OK** to confirm the highlighted option.
- The option chosen will display a **✓** tick beside it.

Rapid Wash

- When this option is selected, the program cycle time is reduced.
- Touch the **▲** and **▼** buttons to highlight the desired option.
- Touch **OK** to confirm the highlighted option.
- The option chosen will display a **✓** tick beside it.

Setting options

- The Setting Menu can be used to change user interface parameters such as **Buzzer**, **Time**, **Code Lock**, **Save in Memory**, **Display Contrast**, **Display Brightness**, **Display Standby and Temperature Unit**.
- To access the Setting Menu switch on the washing machine and select any program.
- To select Settings touch the Menu button on the control panel.
- Touch the **▲** and **▼** buttons to scroll through the options until the setting you want is highlighted and touch **OK** to confirm.

Buzzer settings

- The acoustic signal indicates the start, end, selection and deselection of the program as well as operating actions of malfunctions.
- You can set the buzzer volume to **High**, **Low** or **OFF**.
- Touch the **▲** and **▼** buttons to select the volume level.
- Touch **OK** to confirm the highlighted option.
- The selected option will have a **✓** tick beside it.
- You can change the other settings or touch the **Start/Pause** button to start the program.

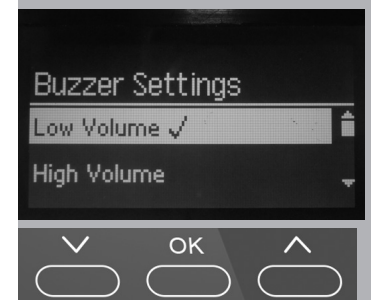

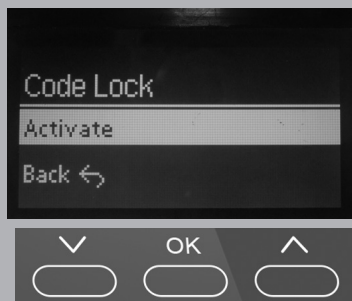

Code Lock

The Code Lock prevents the washing machine being used without your knowledge. When the Code Lock has been activated, you have to enter the code after switching on the washing machine.

To activate the Code Lock

- Touch the **▲** and **▼** buttons to scroll through the options. Touch **OK** when Activate is highlighted.
- Set the desired code by touching the **▲** and **▼** buttons. Touch **OK** to confirm.
- To enter the code use the **▲** and **▼** buttons to enter the first digit. Touch **OK** to confirm.
- Next enter the second digit. Repeat the process till all 4 digits have been entered. Touch **OK** to confirm your Code Lock.
- **Code Lock Activated** will be displayed.

To use washing machine when the Code Lock is activated

- When the washing machine is switched on again the display will request the code.
- Enter the set code to unlock your washing machine.
- **Ready Entry OK** will be displayed if the correct code is entered. **Wrong code Try again** will be displayed if the wrong code is entered.

To deactivate the Code Lock

- To deactivate the Code Lock go to settings.
- Then go to the Code Lock option, select the **Deactivate option** and Touch **OK** to confirm.
- Enter the set code during deactivation.

Note in case you forget the code, it can be activated and deactivated by default factory settings code **1234**.

Time settings

First select a 12 or 24 hour clock format, then set the current time of the day.

Select a clock format

- Use the **▲** and **▼** buttons to scroll through the 12 hour or 24 hour clock format.
- Touch **OK** to confirm the selected clock format.

Set the clock time

- Touch the **▲** button to decrease or the **▼** button to increase the hour.
- Confirm the hour selected with the **OK** button. Then do the same to set the minutes and am/pm in the case of the 12-hour format.

Save in memory

- This option enables you to save all options and settings selected for that particular program.
- Touch the **▲** and **▼** buttons to enable (Yes) or disable (No) Save in memory.
- Touch OK to confirm your selection.
- A tick **✓** will appear beside it once the option is selected.
- The next time you select the program you will have all the settings saved.

Display contrast

This option is used to increase or decrease the display contrast. There are 10 different display contrast settings.

- To select the desired display contrast touch the **▲** and **▼** buttons. The contrast will change as soon as a different setting is chosen.
- Touch **OK** to confirm the desired contrast.

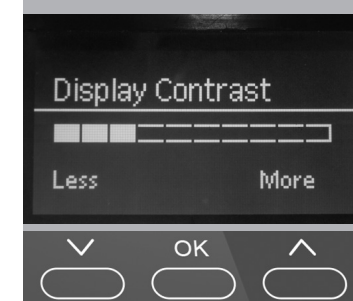
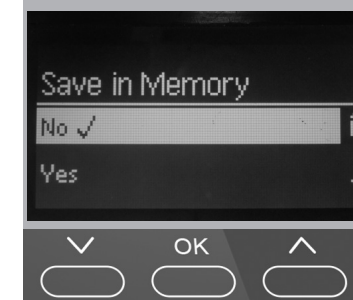



Display brightness

This option is used to increase or decrease the display brightness. There are 10 different display brightness settings.

- To select the desired display brightness touch the **▲** and **▼** buttons. The brightness will change as soon as a different setting is chosen.
- Touch **OK** to confirm the desired brightness.

Display standby

This option is used to enable or disable the standby mode to save power. The display turns off and the indicator light for the **Start/Pause** button starts flashing slowly. This option lets you select whether you want the display to turn OFF 10 minutes after a program has started or remain visible throughout the program. This option is selected 'Yes' by default.

- To select the standby mode touch the **▲** and **▼** buttons to select the desired mode.
- Touch **OK** to confirm the desired selection.
- Once the option is selected a **✓** tick appears beside it.
Yes: The standby function is activated. The display will go OFF 10 minutes after a program has started.
Not in current prog: The standby function is deactivated. The display will remain visible during the program.

Note: Display will turn ON if any button other than the Power button is touched while Display standby function is active Display and LEDs will glow.

Drum Lamp

- If this option is selected, then drum lamp will remain ON for maximum 5 minutes, after power ON, during Pause and during End of the program. During Pause drum lamp will turn ON upon touching any button.
- This option is OFF by default.
- Touch the **▲** and **▼** buttons to put drum lamp ON and OFF.
- Currently set option will have a **✓** tick mark besides it.
- Touch **OK** button to confirm.



6 Start washing

- Touch the **Start/Pause** button to start washing. The Start/Pause LED will glow.
- Touch the **Start/Pause** button once to interrupt the cycle or to add or remove laundry.
- The door lock and unlock status will be shown on the display.
- The door cannot be opened when the water level inside the drum is above the rubber sleeve level or if the water temperature inside the drum is too high.
- The program status can be seen on the display.
- Display will go blank after 10 minutes of starting this program.
- Display will turn ON if any button other than the Power button is touched while the Display Standby function is active. (Refer to Display Standby note for more information.)



Finishing

- Please ensure you take the following steps after the program has ended to ensure safety of your machine.
- When the program ends, 'Program END, Remove washed clothes, Switch OFF the appliance' will be displayed.
- The door can be opened after the above message is displayed.
- The machine has been programmed to switch OFF all visual displays such as LEDs and LCDs to save energy. Start/Pause LED will slowly blink after END of the program. This is in line with the latest Energy Using Product norms (EUP).

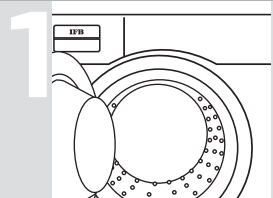

Open door and remove laundry.



Turn the machine OFF and leave the door slightly open. Switch OFF the input power supply to washing machine.



Turn OFF tap.

Washing symbols—a guide



Resistant material



Delicate fabric



Washable at 95°C



Washable at 60°C



Washable at 40°C



Washable at 30°C



Hand wash



Dry clean only



Wool seal



Bleachable in cold water



Do not bleach



Do not dry clean



Dry flat



Hang to dry



Dry on clothes hanger



Tumble dry, normal heat



Tumble dry, reduced heat



Do not tumble dry

Program Option Chart

Programs	Pre Wash	Soak	Extra Rinse	Rinse Hold	Anti Crease	Soilage	Stains	Water Plus	Pet Hair	Quiet Wash	Rapid Wash	Steam
Cotton Normal	✓	✓	✓	✓	✓	#	✓	✓	✓	✓	✓	✓
Cotton Eco	✗	✓	✓	✓	✗	✗	✗	✗	✗	✓	✗	✓
Synthetic	✓	✓	✓	✓	✓	#	✓	✓	✓	✓	✓	✓
Mixed	✓	✓	✓	✓	✓	#	✓	✓	✓	✓	✓	✓
Express Wash	✗	✗	✓	✓	✗	✗	✗	✗	✗	✓	✗	✗
CradleWash®	✗	✗	✓	✓	✗	✗	✗	✗	✗	✓	✗	✗
Repeat Wash	As Per Selected in Last Program											
More Programs												
Dark Wash	✓	✗	✓	✓	✓	#	✗	✓	✓	✓	✓	✗
Curtains	✓	✓	✓	✓	✓	#	✗	✓	✗	✓	✓	✗
Lingerie	✗	✗	✓	✓	✓	#	✗	✗	✗	✓	✓	✗
Silk Saree	✗	✗	✓	✓	✗	✗	✗	✗	✗	✓	✗	✗
Wool	✗	✗	✓	✓	✗	✗	✗	✓	✗	✓	✓	✗
Baby Wear	✗	✗	✓	✓	✓	✗	✗	✗	✗	✓	✓	✓
Tub Clean	✗	✗	✗	✗	✗	✗	✗	✗	✗	✗	✗	✗
Drain	✗	✗	✗	✗	✗	✗	✗	✗	✗	✗	✗	✗
Spin Dry	✗	✗	✗	✗	✓	✗	✗	✗	✗	✓	✗	✗
Additives Rinse+Spin	✗	✗	✓	✓	✓	✗	✗	✓	✗	✓	✗	✗
Demo	✗	✗	✗	✗	✗	✗	✗	✗	✗	✗	✗	✗
Uniform	✓	✓	✓	✓	✓	✗	✗	✓	✓	✓	✓	✓
Cotton Coloureds	✓	✓	✓	✓	✓	#	✗	✓	✓	✓	✓	✗
Jeans	✓	✓	✓	✓	✓	#	✗	✓	✓	✓	✓	✓
Cotton Whites	✓	✓	✓	✓	✓	#	✗	✓	✓	✓	✓	✓
Daily Wash	✓	✓	✓	✓	✓	#	✗	✓	✓	✓	✓	✓
Starch	✗	✗	✗	✓	✓	✗	✗	✓	✗	✓	✗	✗

Programs	Pre Wash	Soak	Extra Rinse	Rinse Hold	Anti Crease	Soilage	Stains	Water Plus	Pet Hair	Quiet Wash	Rapid Wash	Steam
Soft Toys	✗	✓	✓	✓	✗	✗	✗	✗	✗	✓	✓	✓
Shirts	✓	✗	✓	✓	✓	#	✗	✗	✓	✓	✓	✓
Hygiene	✗	✓	#	✓	* *	✗	✗	#	✗	✓	✗	✓
Sanitise	✓	✓	#	✓	* *	#	✗	#	✗	✓	✓	*
Sports Wear	✓	✓	✓	✓	✓	#	✗	✓	✗	✓	✓	✗
Duvet	✗	✓	✓	✓	✓	#	✗	✗	✗	✓	✓	✓
Refresh	✗	✗	✗	✗	#	✗	✗	✗	✗	✗	✗	#

*Option is selected by default and can be deselected

Available by default and cannot be deselected.

* * Selected by default only if steam wash option is selected.

✓ Option available and can be selected.

✗ Option not available and cannot be selected.

Depending on water pressure, water hardness, water inlet temperature, quantity and type of textile, detergent used, foam detection, unbalance detection, degree of soiling, ambient condition, selected additional function and power supply fluctuations, the actual values given in the User Manual or with the machine can deviate from the declared standard values as they are tested according to laboratory conditions. Program time can also skip or extend due to the conditions mentioned above.

The washing machine detects the weight of the laundry during program run and automatically adjusts the Time/Rinse Water. Press and hold the Option button once during program run to check the total number of wash cycles completed by your washing machine.

Note: The design and specifications are subject to change without prior notice due to continuous improvement and product development.

Wash Guide Map

Programs	Delay Start	Settings	Spin Speed RPM	Temperature °C	Laundry Weight Kg	Extra Options
Cotton Normal	✓	✓	400–1400/ No final spin	Cold, 30, 40, 50, 60, 75, 95	9.0	Refer program option
Cotton Eco	✓	✓	400–1400/ No final spin	40, 60**	9.0	
Synthetic	✓	✓	400–800/ No final spin	Cold, 30, 40, 50, 60	3.5	
Mixed	✓	✓	400–1000/ No final spin	20*, 30, 40	3.5	
Express Wash	✓	✓	400–800/ No final spin	30	2.0	
CradleWash®	✓	✓	400–600/ No final spin	Cold 30, 40	2.0	
Repeat Wash	As per last selection					
More Programs						
Dark Wash	✓	✓	400–1000/ No final spin	40	3.0	Refer program option
Curtains	✓	✓	400–800/ No final spin	30, 40	3.0	
Lingerie	✓	✓	400–600/ No final spin	40	1.0	
Silk Saree	✓	✓	400–600/ No final spin	Cold, 40	2.0	
Wool	✓	✓	400–800/ No final spin	30, 40	2.0	
Baby Wear	✓	✓	400–800/ No final spin	60	3.0	
Tub Clean	✗	✓	✗	95	✗	
Drain	✗	✓	✗	✗	✗	
Spin Dry	✓	✓	400–1400	✗	9.0	

Programs	Delay Start	Settings	Spin Speed RPM	Temperature °C	Laundry Weight Kg	Extra Options
Additives Rinse+Spin	✓	✓	400–1400/ No final spin	✗	9.0	Refer program option
Demo	✗	✓	✗	✗	✗	
Uniform	✓	✓	400–800/ No final spin	40, 75	3.0	
Cotton Coloureds	✓	✓	400–1400/ No final spin	Cold	9.0	
Jeans	✓	✓	400–1400/ No final spin	60	3.0	
Cotton Whites	✓	✓	400–1400/ No final spin	95	9.0	
Daily Wash	✓	✓	400–800/ No final spin	40	3.5	Refer program option
Starch	✗	✓	400–800/ No final spin	✗	9.0	
Soft Toys	✓	✓	400–800/ No final spin	30, 40	1.0	
Shirts	✓	✓	400–800/ No final spin	40	3.0	
Hygiene	✓	✓	400–1000/ No final spin	60	3.0	
Sanitise	✓	✓	400–1400/ No final spin	95	9.0	
Sports Wear	✓	✓	400–800/ No final spin	30, 40	2.0	
Duvet	✓	✓	400–800/ No final spin	30, 40	2.0	
Refresh	✗	✓	✗	✗	1.0	

✓ Option available and can be selected.

✗ Option not available and cannot be selected.

** Program setting for BEE test in conformity with and IEC 60456 with maximum spin speed settings.

* Available only in 8014 model.

Available only in 9014 model.



Wash features

Wash Care Program

More than 100 specific wash options for various fabrics ensure the most hygienic wash for your clothes.



Pre Wash

Soiled clothes are put through a preliminary wash, before the main wash to dislodge the dirt. This helps to dislodge the dirt.



Soilage

Can set the program to clean Light/Normal/Heavy impingement of dirt from clothes.



Stains

12 different stains such as Baby Food, Oil, Blood, Chocolate, Sweat, Mud & Sand, Tomato, Coffee, Egg, Tea, Cosmetics and Red Wine can be selected. The washing machine adjusts the washing temperature and wash rhythm for each type.



Child Lock

This safety feature prevents the Program Selection and Wash Options being tampered with by children.



Express Wash

A special program to help wash your lightly soiled clothes faster. Good for gym clothes.



Auto Restart

Program resumes from the interrupted point on resumption of power supply.



3D Wash System

Jets of water and shower from the paddles ensure complete soaking of clothes. With water circulation system, water mixed with detergent gets injected on your clothes with help of spraying mechanism for a better wash.



Air Bubble Wash

Millions of bubbles surround and protect clothes while washing.



Cool Down Cycle

Hot water drained after the main wash cycle can be harmful for people and the environment. Hot water is cooled down by taking additional cold water automatically before draining.



Auto Balance System

If the wash load is very unevenly distributed, the washing machine will re-distribute it so as to balance the load inside the drum. In this process, the washing machine will stop in between and try to re-distribute the load.



Start/Pause (Program Interrupt)

Gives you the liberty to start and pause the program whenever you want.



Anti Crease

A feature that reduces wrinkling of clothes after the final spin, making them easy to iron. Using a lower spin speed can help reduce creasing.



High-Low Voltage Protection

A smart microcontroller continuously monitors the online voltage fluctuations and temporarily stops the program to protect the machine in case the voltage drops below 150 ± 10 V or rises above 270 ± 10 V. The program will resume once the voltage is within safe operating range.



Demo

Special program designed for customers to provide a brief overview of option selection and program operation.



Tub Clean

Eliminates any impurities, scaling, bacteria and unpleasant smells from the washing machine.



Starch

Fabric conditioners make garments soft to handle and help prevent static cling when tumble drying. Starch stiffens and gives body to items of laundry, eg shirts, tablecloths, bed linen.



Pet Hair

Programs designed specially for pet lovers. This program helps remove pet hair from the laundry during the wash cycle.



CradleWash®

India's first wash program for delicate fabrics provides gentle care that uses a soft, to-and-fro, rocking movement.



Rapid Wash

This function reduces washing time compared to normal cycle depending on program and wash mode selected.

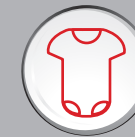

Baby Wear

Program specially designed to tackle the toughest of stains associated with babies and young toddlers.



Soft Toys

A program specially designed to wash soft toys specified as machine washable by the manufacturer.



Laundry Add Option

Lets you add laundry even after the wash cycle has started.

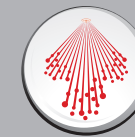

Steam Wash

Gets clothes clean with sanitising effect and reduces wrinkles.



Tips for best results

Before washing

- Empty all pockets.
- Remove metal parts.
- Close any zips and fasten hooks etc before washing.
- Do not wash anything in the machine that is specified as non-machine washable on the wash care label.

While sorting

- Separate polyester fabrics from cotton fabrics.
- Try to have a mix of large and small clothes in each wash load.
- Dark clothes should be washed separately and not with whites.

While loading

- Load large items first, preferably half the wash load.
- Do not wash single items—add one or two similar items.
- Place small items like infants' socks, nylon stockings, handkerchiefs etc in a laundry bag, pillow case or something similar, as they may get caught around the door. This will also save your laundry from getting lost.

Water softening

- Use water softening agents or adjust detergent dosage as recommended by the detergent manufacturer in case of hard water.

Easy tips to remove stains

- Ensure you use warm water for soaking or pre washing stained laundry.
- Fresh stains are easier to remove.
- Knowing what kind of stain it is, how old it is, what kind of fabric it is and whether the fabric is colour-fast (check the care label) always helps treat a stain better.
- Always start with cold or warm water as hot water can set in stains. Washing and drying can sometimes set in stains.
- When bleach is recommended, always use a fabric safe one.
- Put the stained area face down on a paper towel or white cloth. Apply the stain remover to the back of the stain. This forces the stain off the fabric instead of through it.

STAIN	TREATMENT
Chewing gum, Adhesive tape, Rubber, Cement	Use ice in a plastic bag to harden the gum. Scrape off what you can and then sponge with white spirits.
Blood	Rinse immediately in COLD water. If stain remains, soak in cold water with an enzyme pre wash.
Chocolate, Cocoa	Sponge with COLD water and soak in an enzyme pre wash. If stain persists, rub a little detergent and rinse in COLD water.
Coffee	Blot up quickly and rinse out in COLD water. Rub in a little detergent and wash in the maximum temperature allowed for the fabric type.
Cream, Milk, Ice cream	Rinse in COLD water and wash normally. If stain is still apparent, sponge with white spirits.

STAIN	TREATMENT
Deodorant	Rub affected area with white vinegar and then rinse out in COLD water. Sponge with white spirits. Treat stiffened areas with enzyme pre wash.
Egg	Soak in a COLD enzyme pre wash, rinse and wash normally.
Fabric softener	Rub affected areas with bar soap and wash normally.
Fruit	Treat as soon as possible by sponging with cold water. Rub a little detergent on the stain and wash normally.
Grass	Sponge with white spirits. Rub in an enzyme before wash and wash normally.
Grease, Oil	Lay the affected area face down on an absorbent cloth and work from the back. Sponge with white spirits or dry cleaning fluid. Wash normally.
Iron, Rust	Apply lemon juice and salt and place in the sun. Wash normally.
Collars, Cuffs, Cosmetics	Pre-treat with pre wash stain remover or rub with a soap bar.
Mildew	Wash in WARM water and detergent. Moisten area with lemon juice, dry in the sun and wash normally. If stain persists and fabric allows, use bleach.
Mud	Brush off dry mud and rinse in COLD water. If stain persists rub in a little detergent and wash normally.

STAIN	TREATMENT
Paint—oil based	Scrape off any fresh paint and sponge with a non-flammable dry cleaning fluid and wash normally.
Paint—water based	Treat while still wet. Rinse in WARM water and wash normally.
Scorch marks	Dampen a cloth with hydrogen peroxide, lay it over the affected area and touch with a fairly hot iron.
Ink	Some inks may be impossible to remove and washing may even set it in. Use pre wash stain remover, denatured alcohol or non-flammable dry cleaning fluid.
Nail polish	May be impossible to remove in some cases. Place stain face down on paper towels. Apply nail polish remover to the back of stain. Repeat, placing paper towels frequently. Do not use acetate fabrics.
Shoe polish	Liquid: Pre-treat with a paste of granular detergent and water. Paste: Scrape residue from fabric. Pre-treat with pre wash stain remover or non-flammable dry cleaning fluid. Apply detergent into dampened area and wash using bleach safe for fabric.
Candle wax, Crayon	Scrape off surface wax. Place stain face down between paper towels. Touch with warm iron until wax is absorbed. Replace paper towels frequently. Treat remaining stain with pre wash stain remover or non-flammable dry cleaning fluid. Hand wash to remove solvent and wash using bleach safe for fabric.

Maintenance and cleaning of your washing machine

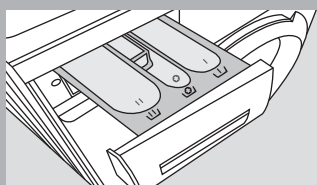

Cleaning the detergent dispenser drawer

- Remove detergent residues regularly.
- Pull out the detergent dispenser drawer completely.
- Clean the detergent dispenser drawer with warm water.
- Clean the siphon. Remove the siphon from the compartment and wash under running warm water.
- Detergent residues can build up in the water jets on top of the detergent dispenser drawer housing.
- Before fixing the detergent dispenser drawer, use a bottle brush to clean it out.
- If starch is used, thoroughly clean siphon and siphon tube regularly. A build up of starch will lead to clogging.

Cleaning the water hose mesh filter

- Turn OFF taps. Disconnect power supply to the machine. Unscrew the inlet hose from machine and the tap. Drain water from the hose.
- Remove the filter mesh from the tap end of the inlet hose and clean under running water with a brush.
- Pull the sieve out of the magnetic valve with a pair of flat nosed pliers. Clean the sieve under running water with a brush. Then fit the sieve back into the valve.

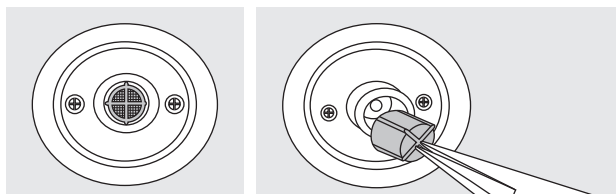
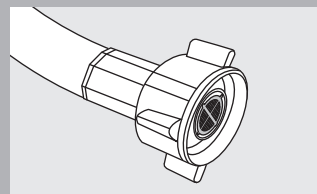
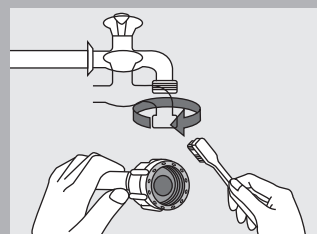

- Screw inlet hose back to the machine and the tap. Ensure that the sieve and filter are in place. Turn ON the water tap to check if the connection is watertight.

Note Presence of excess dirt/sediments/sand in water can affect the wash quality as well as the reliability of water inlet valve

Cleaning the filter

- Filter should be cleaned more frequently in order to increase the life of the drain pump.

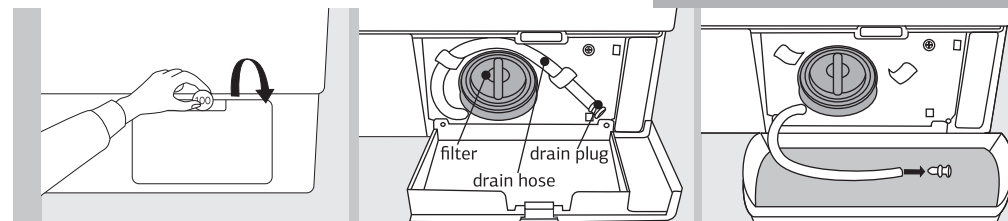

- Open the detachable bottom door by using a coin or key.
- Place a shallow container near the bottom door. Pull out the drain hose and open the drain plug to drain out the water from the machine in the container.
- After draining the water through the drain plug, open the filter by rotating it anti-clockwise and remove foreign objects like coins, pins or hooks, if any.

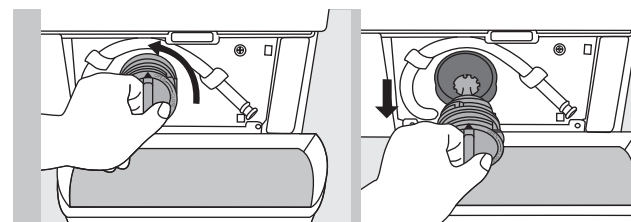

- Tighten the filter and drain plug to their original positions and close the bottom door.
- Do not open the filter during a program run.

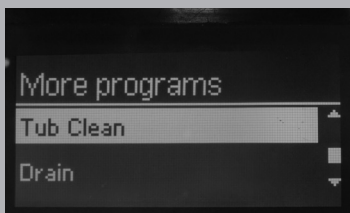
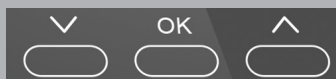
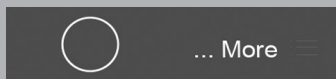

DESCAL
Appliance Descaler
brought to you by IFB.
Call IFB Care for details.

IFB
essentials

DESCAL | Appliance Descaler



Tub Clean program

Run this program to eliminate any impurities, scaling, bacteria and unpleasant smell from the washing machine.

Before running **Tub Clean** program, empty the washing machine drum; there shouldn't be any clothes in the washing machine during **Tub Clean** program.

Do not put laundry in the washing machine during Tub Clean.

To run Tub Clean program

- Switch on the washing machine.
- Touch the **More Programs** button.
- Touch **▲** & **▼** buttons to scroll through the list of programs of programs.
- Touch **OK** when Tub Clean is highlighted.
- Touch the **Start/Pause** button to run the program.
- **END** will be displayed after the program ends.
- If you do not regularly use washing programs with temperatures over 60°C, it is recommended to run **Tub Clean** at least once a month.

Use of descalant

- Use descalant periodically to increase the life of the heater and to remove scaling on the heater and drum owing to hard water.
- Follow instructions of the descalant manufacturer and make sure that there is no laundry in the washing machine while using it.
- Only use proprietary non-corrosive descaling agents.

Cloth weights

Bottoms

Lungi/Dhoti	200 g
Skirts	200 g
Trousers	250 g
Jeans	400 g

Tops

Cotton shirts	280 g
Other shirts	200 g
Cotton blouses	140 g
Other blouses	100 g
Woollen sweaters	400 g
Heavy sweaters	300 g
Light sweaters	150 g

Other clothes

Cotton saree	650 g
Synthetic saree	350 g
Bath towels	600 g
Hand towels	250 g
Pyjama kurta	400 g
Panties	60 g
Cotton vests	100 g
Underslips	100 g
Long socks, 2 pairs	150 g
Short socks, 2 pairs	85 g
6 handkerchiefs	85 g
12 napkins	1.1 Kg

Sheets

Cotton (double)	1 Kg
Cotton (single)	500 g
Non cotton (double)	650 g
Non cotton (single)	400 g

Pillow slips

Cotton pillow slips	110 g
Other pillow slips	85 g

Tablecloths

Small	230 g
Large	600 g
Table napkins (4)	150 g

Bedsread

	3 Kg
--	------

Blankets

Wool	2 Kg
Acrylic	1.5 Kg



Let's make washing easier.
Here is a list of clothes
and their approximate
weights to help you figure out
a perfect wash load.

Laundry Items	8.5 Kg	9 Kg
Bath towels	3	3
Shirts	4	4
Blouses	3	4
Skirts	5	5
Pair of pants	1	2
Pairs of jeans	3	3
T-shirts	4	4
Sets of pyjamas	4	4
Tea towels	4	4

The chart indicates average weights of clothes. The recommended weight of your wash load should not be exceeded to ensure that your machine gives your clothes an effective wash. Suggested weights are approximate and may vary.

Troubleshooting

When the washing machine does not function properly, check the following points before you contact your service provider.

SYMPTOM LCD Display does not glow.

PROBABLE CAUSE	SOLUTION
<ul style="list-style-type: none"> Power supply is not turned ON. Electrical power cord may not be plugged in or connection may be loose. Power button is not pressed. 	<ul style="list-style-type: none"> Ensure that the supply mains switch is ON. Make sure that the plug is plugged in and check for loose connection in plug/socket. Press Power button and then select program.

SYMPTOM Washing machine door does not open.

PROBABLE CAUSE	SOLUTION
<ul style="list-style-type: none"> Machine is in operation. Door open not possible. Child Lock is active. 	<ul style="list-style-type: none"> Check if the program is active. If yes, pause the program and check if 'Door Unlocking Pls Wait' or 'Door open possible' message is shown. For safety reasons, the washing machine door cannot be opened when water level, temperature or speed is too high. Check if 'Door Unlocking' or 'Door Open not possible' message is displayed. Disable the Child Lock and wait for 1–2 minutes till 'Door open possible' or 'Remove Washed Clothes', 'Switch OFF appliance' is displayed.

SYMPTOM Program does not start.

PROBABLE CAUSE	SOLUTION
<ul style="list-style-type: none"> Machine Start/Pause button not touched. Water supply tap not turned ON/ no water supply/low water pressure. Door not closed properly. Program either in Pause/Soak or Rinse Hold mode. 	<ul style="list-style-type: none"> Ensure that the Start/Pause button is touched. Start/Pause LED will glow when touched. Open tap fully and ensure that there is water supply with normal water pressure. Open and close the door firmly. Check the status on the display and refer to the user manual.

SYMPTOM Water does not enter into machine. Detergent not being flushed into the drum.

PROBABLE CAUSE	SOLUTION
<ul style="list-style-type: none"> Water supply tap not turned ON/ no water supply/low water pressure. Door not closed properly. Bent inlet hose, sieve or inlet valve/inlet hose clogged. 	<ul style="list-style-type: none"> Open the tap fully and ensure that there is water supply with normal water pressure. Open and close the door firmly. Check if the inlet hose is bent or sieve is blocked.

SYMPTOM Suds escaping from detergent dispenser tray. Excessive foam in drum. Residues of detergent on clothes.

PROBABLE CAUSE	SOLUTION
<ul style="list-style-type: none"> Detergent used is not a Front Loader detergent. Excessive detergent used. Overloading of clothes. Cold wash program. Low water pressure. 	<ul style="list-style-type: none"> Use detergent recommended for Front Loader washing machines only. Reduce the detergent dosage. Do not overload the washer. Use hot wash program. Start when water pressure is normal.

SYMPTOM Water leakage from machine.

PROBABLE CAUSE	SOLUTION
<ul style="list-style-type: none"> Inlet hose connection loose. Filter not tightened. Inlet hose leaking. 	<ul style="list-style-type: none"> Check and tighten the inlet hose connection. Check and tighten the filter. Contact IFB Care.

SYMPTOM Machine does not drain.

PROBABLE CAUSE	SOLUTION
<ul style="list-style-type: none"> Filter clogged. Drain hose end above 1 metre from the floor level. Drain hose kinked or clogged. 	<ul style="list-style-type: none"> Check and clean the filter. Drain hose should be placed between 1 metre to ground level. Clean and straighten the drain hose.

SYMPTOM Machine does not spin or clothes stay wet.**PROBABLE CAUSE**

- Load is too small. Unbalanced load.
- Overloading of clothes.
- Spin Speed is set to ORPM or lower Spin Speed is selected.
- Rinse Hold option selected.
- Filter clogged.
- Excessive/high foaming detergent.

SOLUTION

- Add 1 or 2 similar items to help balance the load. Rearrange load to allow proper spinning.
- Load clothes as per the fabric type and capacity recommended for chosen program.
- Select higher Spin Speed.
- At Rinse Hold stage touch 'Start/Pause' button.
- Check and clean filter.
- Use detergent recommended for Front Loader washing machines only.

SYMPTOM Machine vibrates more during spinning.**PROBABLE CAUSE**

- Machine not levelled properly.
- Filter clogged partially.
- Unbalanced load.

SOLUTION

- Check and level the machine.
- Check and clean the filter.
- Add 1 or 2 similar items to help balance the load. Rearrange load to allow proper spinning.

SYMPTOM Motor noise.

- It is normal for noises to be heard while motor is running.

SYMPTOM Pump noise.

- It is normal for noises to be heard from the pump during the start up and final stage of draining. However check for filter clogging.

**SYMPTOM Program cycle time delayed.
Balance time on display remains unchanged.**

- It is normal as the washing machine time may vary depending upon the type and quantity of laundry, inlet water pressure, inlet water temperature, variations in power supply and other usage conditions.
- If there is an unbalanced load then the machine may make several attempts to redistribute the clothes in order to minimise the vibrations resulting in an extended program duration.

SYMPTOM Poor soil removal.**PROBABLE CAUSE**

- Incorrect detergent dosage.
- Use of cold wash program.
- Load size not as per capacity.
- Stains on clothes.
- Mix of heavily soiled items with lightly soiled items.

SOLUTION

- Use correct amount of detergent for load size and water hardness.
- Use hot wash program.
- Use correct load size.
- Pre-treat stain and any soil according to directions given under 'Easy tips to remove stains'.
- Separate heavily soiled items from lightly soiled ones.

SYMPTOM Blue stains on clothes.**PROBABLE CAUSE**

- Excessive fabric additives.
- Cheaper quality additives.

SOLUTION

- Do not overfill fabric softener and do not pour liquid fabric softener directly onto fabric.

SYMPTOM Black or grey marks on clothes.**PROBABLE CAUSE**

- Less quantity detergent/hard water.
- Some clothes already with existing stains.

SOLUTION

- Use correct amount of detergent for load size, amount of soil and water hardness.
- Do not mix good clothes with stained clothes.

SYMPTOM Yellow or brown rust stains.**PROBABLE CAUSE**

- Dirty incoming water.

SOLUTION

- Before washing run water for a few minutes to clean lines or start the program only when the water is clean.
- To restore discoloured load of whites use a rust remover safe for fabric.

SYMPTOM Residue of detergent.**PROBABLE CAUSE**

- Overloading of clothes.
- Excessive use of detergent.
- Cold wash program.

SOLUTION

- Do not overload the washer.
- Use proper amount of detergent.
- Use hot wash program.

SYMPTOM Buttons not working.**PROBABLE CAUSE**

- Button not pressed/touched properly.

SOLUTION

- All the buttons are sensitive and need to be gently tapped/touched with the finger.

If the problem persists, contact IFB Care.

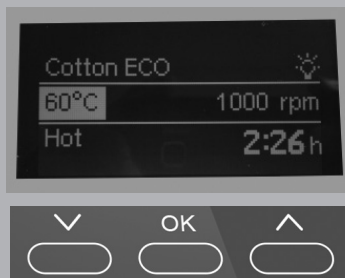

Display

The LCD Display gives you complete information

- Program selection.
- Additional wash option selection.
- Balance time of the program.
- Program status.
- Problem/fault indications, if any.
- Child Lock selection.
- Door Status.

For any code that is not present in the following list or if the suggested solution doesn't fix the problem, call IFB Care.

DISPLAY MESSAGE	PROBABLE CAUSES	SOLUTION
Program END and Deactivate Child Lock	Child Lock is selected.	Disable Child Lock by touching Anti Crease and Menu buttons
Child Lock Active	Child Lock is selected.	Disable Child Lock by touching Anti Crease and Menu buttons
Paused, Door open not possible	For safety reasons, washing machine door cannot be opened when water level, temperature or speed is too high	
Code Lock 0000	Code Lock has been activated by user	Enter a saved code, confirm the entry. Deactivate code if you don't want this message to reappear next when the machine is switched ON. Refer to information on 'Code Lock' page.

DISPLAY MESSAGE	PROBABLE CAUSES	SOLUTION
Rinse Hold Start/Pause button flashing	Rinse Hold option is selected.	Select Spin Speed or touch Start button or select Drain program.
Program Start in (Time)	Delay Start option is selected.	Program will resume automatically after delay period is over.
Error Door Open? Please Close	Door not closed properly. Door not locked.	Open and then close the door firmly.
Error Door Locked Switch OFF and Restart	Door not getting unlocked.	Switch OFF the appliance by pressing the power button. Wait for 2 minutes and check if the door can open. Do not try to open the door forcibly. If the same message is displayed switch OFF the appliance and contact IFB Care.
Error No water? Check tap or Wait for Water	Water tap turned OFF. Water supply not available or low water pressure.	Turn on the tap. Washing machine will start automatically on resumption of water supply.
Error Low Water Pressure? Sieve/Mesh Filter Blocked?	Sieve/filter blocked in water inlet hose. Bent/damage water inlet hose.	Clean sieve filter (refer cleaning the water hose mesh filter). Remove bend/damage.

DISPLAY MESSAGE**PROBABLE CAUSES****SOLUTION**

Error
Pressostat
Switch OFF and Restart

Switch OFF the machine by pressing the Power button. Wait for 2 secs and restart. If the same message is displayed, turn OFF the tap, switch OFF the appliance and contact IFB Care.

Error
Motor
Switch OFF and Restart

Cloth trapped between drum and door area.

Switch off the machine by pressing the Power button. Wait for 2 secs. Run Drain program. After End, rearrange the clothes and restart the required program. If the same message appears again, switch OFF the appliance and contact IFB Care.

Error
Motor Triac
Switch OFF and Restart

Water temperature is above 60°C at the start of the program.

Start New/Drain program once water cools down to approximately 60°C. Switch off the machine by pressing the Power button. Wait for 2 secs and restart. If the same message appears again, switch OFF the appliance and contact IFB Care.

Error
Over Heating Or NTC
Switch OFF and Restart

Error
Drain Or Pressostat
Pump Filter Blocked?

Water not drained.

Filter blocked.

Exhaust hose clogged/bent.

Touch Start/Pause button to restart the drain. Switch OFF the appliance. Drain out the water using drain plug and then clean filter.

Clean exhaust hose/remove bend.

Error
Low Voltage
Wait/Switch OFF

If input voltage is low, machine will start automatically after the voltage increases to safe operating level. If this error persists or occurs frequently, contact your electrician to locate the electrical fault.

DISPLAY MESSAGE**PROBABLE CAUSES****SOLUTION**

Error
High Voltage
Wait/Switch OFF

If input voltage is high, machine will start automatically after the voltage reduces to safe operating level. If this error persists or occurs frequently, contact your electrician to locate the electrical fault.

Error
Program END
High unbalanced load
Refer User Manual

Laundry load is unbalanced.

If laundry load is small (eg a pair of jeans, 2–3 Turkish towels, bathrobe etc) it can lead to an unbalanced condition. Add 1–2 similar items to help balance the load and rearrange load to allow proper spinning.

Error Communication

Switch off the machine by pressing power button and wait for 2 secs, then restart. If the same message appears, switch OFF the machine and contact IFB Care.

Error Steam

Cancel the program, switch OFF the appliance by pressing the power button, wait for 2 secs and restart. If the error persists, turn OFF the tap, cancel the program, switch OFF the appliance and contact IFB Care.



Technical specifications

Model	Senator Smart Touch 8.5 Kg 1400RPM Executive Smart Touch WMS/SXS 9014
Power supply	220–240 V Single Phase 50 Hz
Dimensions	60.6 cm (D) x 59.8 cm (W) x 87.5 cm (H)
Net weight	72 Kg
Capacity	8.5 Kg of dry cotton 9.0 Kg of dry cotton
Wash care programs	28 (>100 with options)
Selector buttons	Programs, Options, Start/Pause, Power, Menu, Steam Wash Λ and V, OK
Spin speed	400–1400RPM or Spin Cancel
Water consumption*	≤ 9 Ltr/Kg/Cycle
Water pressure	0.3 Bar–10 Bar (3.5–10 Ltr/min)
Power consumption max	2150 W (8.5 Kg) 2200 W (9.0 Kg)
Drain pump rating	30 W
Heater rating	2000 W
Drum	Stainless Steel

*Program setting for BEE test in conformity
with IEC 60456.

4

**IFB
CARE**

CALL 08045845678



Installation report

Model _____ Serial no _____

Customer's name _____

Phone (residence) _____ (office) _____

Address _____

Installation check points

Machine delivered on _____

Machine installed on _____

Service engineer to tick appropriately

• Any major transit damage to the machine observed?	yes <input type="checkbox"/>	no <input type="checkbox"/>
• Condition of earthing? Plug Point (16 Amp 220–240 V AC with MCB or other automatic short circuit protection devices) good? If poor, has customer been advised to correct the same?	yes <input type="checkbox"/>	no <input type="checkbox"/>
• Advised to turn OFF machine after use?	yes <input type="checkbox"/>	no <input type="checkbox"/>
• Voltage cut out (high/low) fitted if voltage fluctuations high in area?	yes <input type="checkbox"/>	no <input type="checkbox"/>
• Machine levelling procedure and importance explained?	yes <input type="checkbox"/>	no <input type="checkbox"/>
• Detergents and bleach recommendation—relevant DD tray chambers explained?	yes <input type="checkbox"/>	no <input type="checkbox"/>
• Safety instructions explained?	yes <input type="checkbox"/>	no <input type="checkbox"/>
• Explained all features of washing machine to the customer?	yes <input type="checkbox"/>	no <input type="checkbox"/>
• Display function explained (if applicable)?	yes <input type="checkbox"/>	no <input type="checkbox"/>

Service engineer to tick appropriately

- | | | |
|--|------------------------------|-----------------------------|
| • Explained procedure for cleaning rubber sleeve/coin trap/inlet hose filter? | yes <input type="checkbox"/> | no <input type="checkbox"/> |
| • Explained common error codes (if applicable)? | yes <input type="checkbox"/> | no <input type="checkbox"/> |
| • Explained unbalance error in Spin mode? | yes <input type="checkbox"/> | no <input type="checkbox"/> |
| • Explained program selection, program and button options (or knobs), indicator lamp/status LED/LCD function, buzzer function (if applicable)? | yes <input type="checkbox"/> | no <input type="checkbox"/> |
| • Explained troubleshooting? | yes <input type="checkbox"/> | no <input type="checkbox"/> |
| • Check following for proper order | | |
| - Inlet hose | yes <input type="checkbox"/> | no <input type="checkbox"/> |
| - DD tray | yes <input type="checkbox"/> | no <input type="checkbox"/> |
| - Rat protection mesh cut-outs fitted | yes <input type="checkbox"/> | no <input type="checkbox"/> |
| - Drain hose | yes <input type="checkbox"/> | no <input type="checkbox"/> |
| • Informed user of need to keep drain hose straight and maximum height of draining? | yes <input type="checkbox"/> | no <input type="checkbox"/> |
| • Demo given to customer? | yes <input type="checkbox"/> | no <input type="checkbox"/> |
| • Warranty terms explained? | yes <input type="checkbox"/> | no <input type="checkbox"/> |

Installed by _____ Signature _____

Customer's response

- The installation person was courteous and helpful yes ☐ no ☐

- I would describe my experience with the process of installation as

Unacceptable ☐ Satisfactory ☐ Non-satisfactory ☐ Very satisfactory ☐

I certify that the above information and checks have been done to my satisfaction and I am fully satisfied with the installation of the washing machine.

Customer's signature	Date	Time
----------------------	------	------

Date _____ **Time** _____

Time

Service record

[illegible]



IFB
Set Yourself Free

Businesswoman
in the morning

Blogger by evening
Indulge in your passion.
Do more with your time.
Set Yourself Free with IFB.

Warranty—Customer copy

Model _____

Serial no _____

Dealer's name _____

Date of purchase _____

Customer's name _____

Address _____

Phone _____

Email _____

Motor serial no _____

4

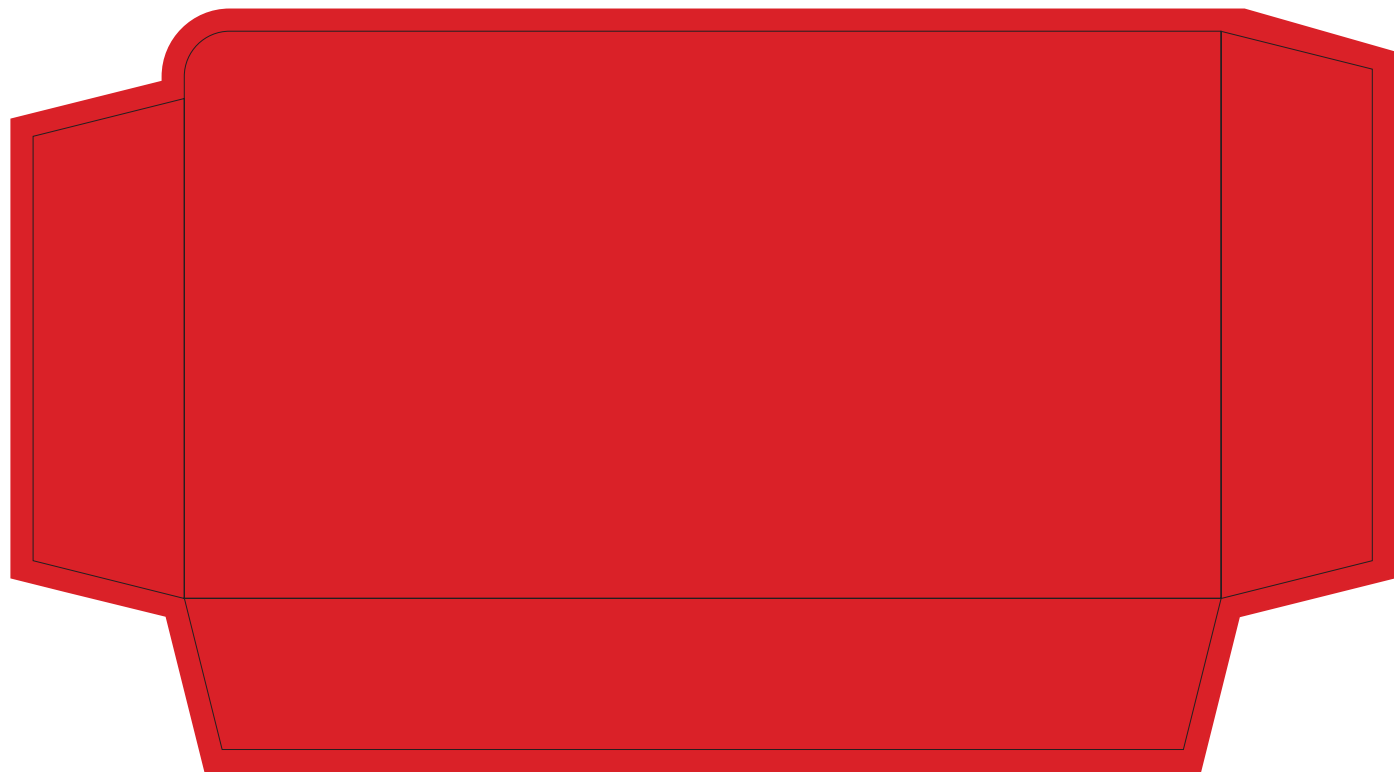

NOT TO BE PRINTED

TITLE	Characteristic Symbol	
User Manual	Critical	(Cc)
Senator Smart Touch 8.5 KG 1400RPM Executive Smart Touch WMS/SXS 9014	Significant	(Sc)
MATERIAL	Manual No	Revision
PAPER	UF421PKMAN293	A
IFB Industries Limited, Goa		

[illegible]

WARRANTY

IFB Industries Ltd (the Company) warrants to the original domestic purchases of this washing machine (Appliance) that it is free from defects in workmanship and material. During 4 Years (48 months) from the date of purchase of the new washing machine all the parts of the washing machine which prove to be defective in workmanship and/or materials shall be replaced or repaired free of charge on intimation to the Company/Company's authorised service centre nearest to the place where the appliance is installed. During 10 years (120 months) from the date of purchase of the new washing machine, the motor which proves to be defective in workmanship and/or materials shall be replaced or repaired free of charge on intimation to the Company/Company's authorised service centre nearest to the place where the appliance is installed.

The warranty is subject to limitations of warranty.

LIMITATIONS OF WARRANTY

- 1) This Warranty is not valid in case of the following events:
 - a) If the Warranty Card is not fully and properly filled in and signed at the time of purchase or installation by the Company's authorised dealer/service engineer.
 - b) If the completed Warranty Card is not presented to the authorised personnel at the time of service/repair.
 - c) If the appliance is not used in accordance with manufacturer's instructions given in the 'User Manual'
 - d) If the washing machine has been installed, serviced, repaired, opened or tampered with by unauthorised personnel
 - e) If defects arise/caused by accidents, alteration, misuse, neglect, abuse, substitution of original components with spurious/non genuine components, attack by household pests/rodents, fire, flood earthquake, lighting and/or any other acts of God/natural calamities.
 - f) If defect arise with unauthorised optional accessories such as trolley, rat mesh, machine cover, online filter, inlet/exhaust extension hose, tap adapter, extended power supply cable, adjustment feet cover etc.
 - g) If damages occur by improper electrical circuits outside the washing machine or by any electrical supply thereof
 - h) If the machine serial number on the appliance is defaced, missing or altered.
 - i) If sea water or any sub-standard detergent has been used in the appliance.
 - j) If the appliance is taken out of India.
- 2) This Warranty does not cover any type of painting or plating, including rusting etc or defects thereof.
- 3) The Company is not liable for any incidental or consequential damages.
- 4) Parts replaced or repaired under this Warranty are warrantied throughout the remaining of the original Warranty period
- 5) The Company is not liable for any delay in servicing due to reasons beyond the control of the Company or any of its authorised service centres.
- 6) This Warranty is not applicable if the washing machine is used for commercial purpose or at places such as institutions, hostels, hospitals, community halls or in other similar applications.
- 7) For any service under this Warranty beyond city/town/municipal limits from the Company/authorised service centre, a fixed charge of ₹250 will be collected from the customer in addition to the actual to and fro charges by the shortest route. Alternatively, the customer can bring the appliance to the nearest service centre for carrying out the necessary repairs, at their own cost.
- 8) To avail the 10 years motor warranty, customers should get the machine serviced only by an IFB authorised service partner.
- 9) Any issue other than the motor arising outside the warranty period of 4 years, will be repaired on a chargeable basis.
- 10) Repair/service charges for any issue with the motor outside the 10 years motor warranty period, will be payable by the customer.
- 11) IFB's decision in this regard shall be final and binding on the customer.